

LEGEND:
 --- LAND MADE AVAILABLE (LMA)

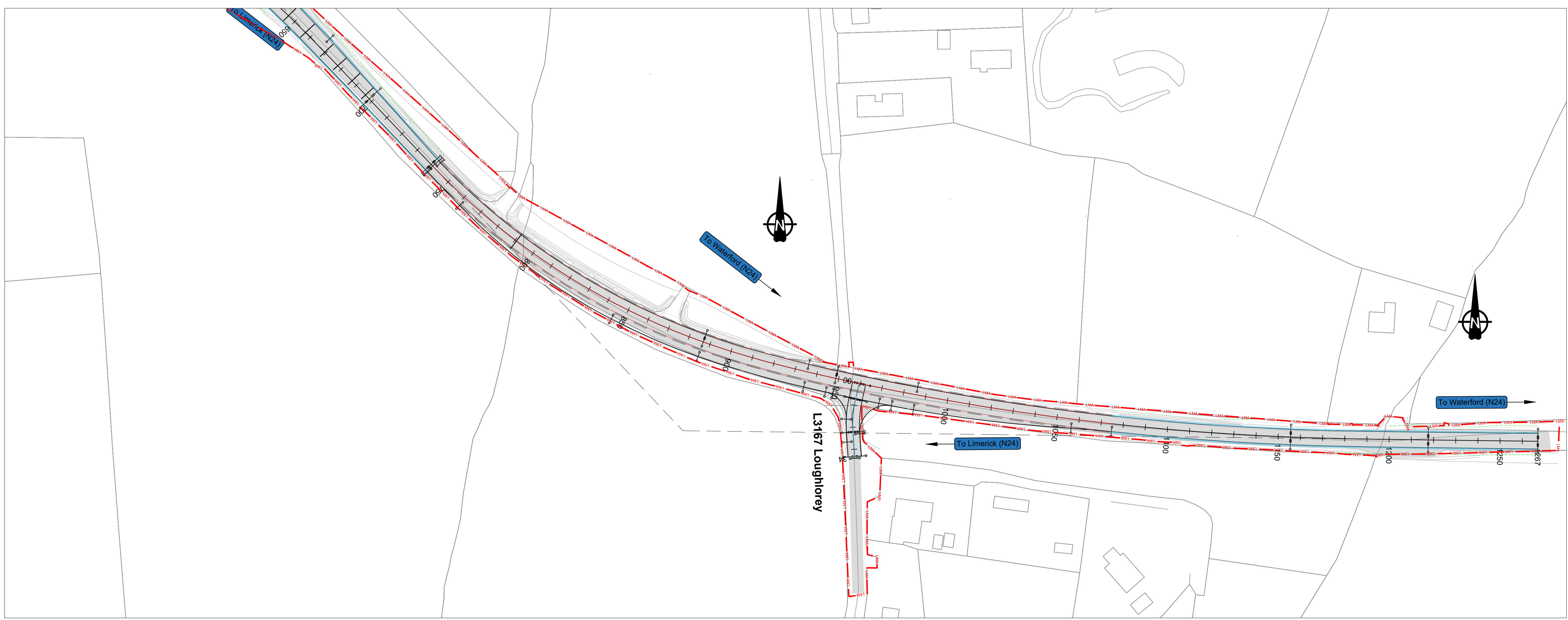

© Ordnance Survey Ireland.
 All rights reserved.
 Licence number:
 2023/10/CCMA/TipperaryCountyCouncil.

NO.	Initials	Date	Description
B	PR	14-04-2023	PART 8 APPLICATION
A	LF	21-7-20	PRELIMINARY DESIGN

Scheme :-
 N24 KNOCKAGH PAVEMENT
 IMPROVEMENT SCHEME

Drawing title :-
 SCHEME LAYOUT
 (SHEET 1 OF 1)

Director Of Services :-
 MARCUS O'CONNOR
Senior Engineer :-
 JOHN NOLAN

Drawn By :-
 P.R.
Designed By :-
 O.T./E.S.

Surveyed By :-
 OS Detail & iGeomatics
Checked By :-
 O.T.

Scale :-
 1: 1000
Date :-
 JULY 2022

Drawing No. :-
 N24-KNOCKAGH-000-002

Drawing Path :-
 T:\Groups\Roads Capital\3-PI\PI007 N24 Knockagh\06 Gwy1
 PARR.0604 Design\Working\PR\Part 8 Drawings\DWG Drawings