

PLANTING SCHEDULE

Type	Location	Species	Common Name	Quantity	Size	Notes
Street Tree	T1	Carpinus betulus 'Frans Fontaine'	Upright Hornbeam	29 no.	20-25 cmg.	
	T2	Sorbus aria 'lutescens'	Native Whitebeam	6 no.	10-12 cmg.	
Feature Tree	T3	Betula utilis 'Jaccquemontii'	Himalayan Birch	1 no.	Multi-stem	Wesley Square Feature Tree
	T4	Betula nigra 'Little King'	River Birch (Little King)	6 no.	Multi-stem	
	T5	Amelechier lamarkii	Showy Mesplis	5 no.	Multi-stem	

Location	Indicative Species	Common Name	Type	Mix	Size
Urban Habitat Pocket (Refer to Sheet L904)	Achillea 'Cerise Queen'	Wildflower Yarrow	Herbaceous Perennial	5%	1-2 litre pot
	Allium sphaerocephalon	Ornamental Onion	Herbaceous Perennial	5%	
	Astilbe 'Younique Carmine'	False Gostsbeard	Herbaceous Perennial	5%	
	Campanula glomerata	Bellflower	Herbaceous Perennial	5%	
	Carex pendula	Pendulous Sedge	Perennial Grass	5%	
	Echinacea purpurea	Purple Coneflower	Herbaceous Perennial	5%	
	Iris pseudococcus	Yellow Flag Iris	Herbaceous Perennial	5%	
	Iris sibirica	Siberian iris	Herbaceous Perennial	5%	
	Juncus effusus	Soft Rush	Perennial Grass	10%	
	Lobelia cardinalis	Cardinal Flower	Herbaceous Perennial	5%	
	Lythrum salicaria	Purple Loosestrife	Herbaceous Perennial	5%	
	Miscanthus sinensis	Silver Grass	Ornamental Grass	10%	
	Osmunda regalis	Royal Fern	Deciduous Fern	10%	
	Panicum virgatum 'Heavy Metal'	Switchgrass	Perennial Grass	10%	
	Stipa tenuissima	Pony Tails	Perennial Grass	5%	
	Verbena bonariensis	purpletop Vervain	Herbaceous Perennial	5%	

NOTES

Category	Note
Protection of existing vegetation	Tree protection shall be erected in accordance with the specifications within Paragraph 9 BS5837 'Trees in Relation to Construction Sites Recommendations 2005.'
Groundworks	All excavations to comply with BS 8000-1:1989 'Part 1: Code of Practice for Excavation and Filling' Sections 3.1, 3.2 and 3.3
Topsoil	If required due to existing topsoil deficiencies any imported topsoil shall comply with BS 3882:2007 Multi-Purpose Grade (natural source) have a medium texture and a pH of 5.5 to 7.8.
Plant Material	All plant material shall be nursery grown and shall be obtained from reputable suppliers. All trees, and shrub material shall comply with the general requirements and where applicable, the specific requirements for nursery stock as set out in BS 3936 in all its applicable parts, BS 4043:1989 'Recommendations for Transplanting Root-balled Trees' and BS 5236:1975 'Recommendations for Cultivation and Planting of Trees in the Advanced Nursery Stock Category'. Shrubs will generally be 9-Sit pot grown and planted at 5-7 plants per m2
Planting works general requirements	Planting shall comply with BS 4428:1989 'Code of Practice for General Landscape Operations (Excluding Hard Surfaces AMD 6784)'. Advanced Nursery Stock Semi-Mature, Extra Heavy Standard Trees: All planting shall be carried out in accordance with BS 4043:1989.
Bed planting of ornamental shrubs	Shrub planting shall conform to: BS 3936-1:1992 'Nursery Stock - Part 1 Specification for Trees and Shrubs', BS 3936-10:1990 'Nursery Stock - Part 10: and BS4428: 1989: Specification for Ground Cover Plants' and BS 4428:1989 'Code of Practice for General Landscape Operations (Excluding Hard Surfaces)'. The design will adhere to the following technical standards: BS 7533-8:2003 Pavements constructed with clay, natural stone or concrete pavers. Guide for the structural design of lightly trafficked pavements of precast concrete flags and natural stone flags; BSBS 7533-10:2010 Pavements constructed with clay, natural stone or concrete pavers. Guide for the structural design of trafficked pavements constructed of natural stone sets and bound construction with concrete paving blocks; BS 7533-12:2006 Pavements constructed with clay, natural stone or concrete pavers. Guide to the structural design of trafficked pavements constructed on a bound base using concrete paving flags and natural stone slabs.
BS Standards	

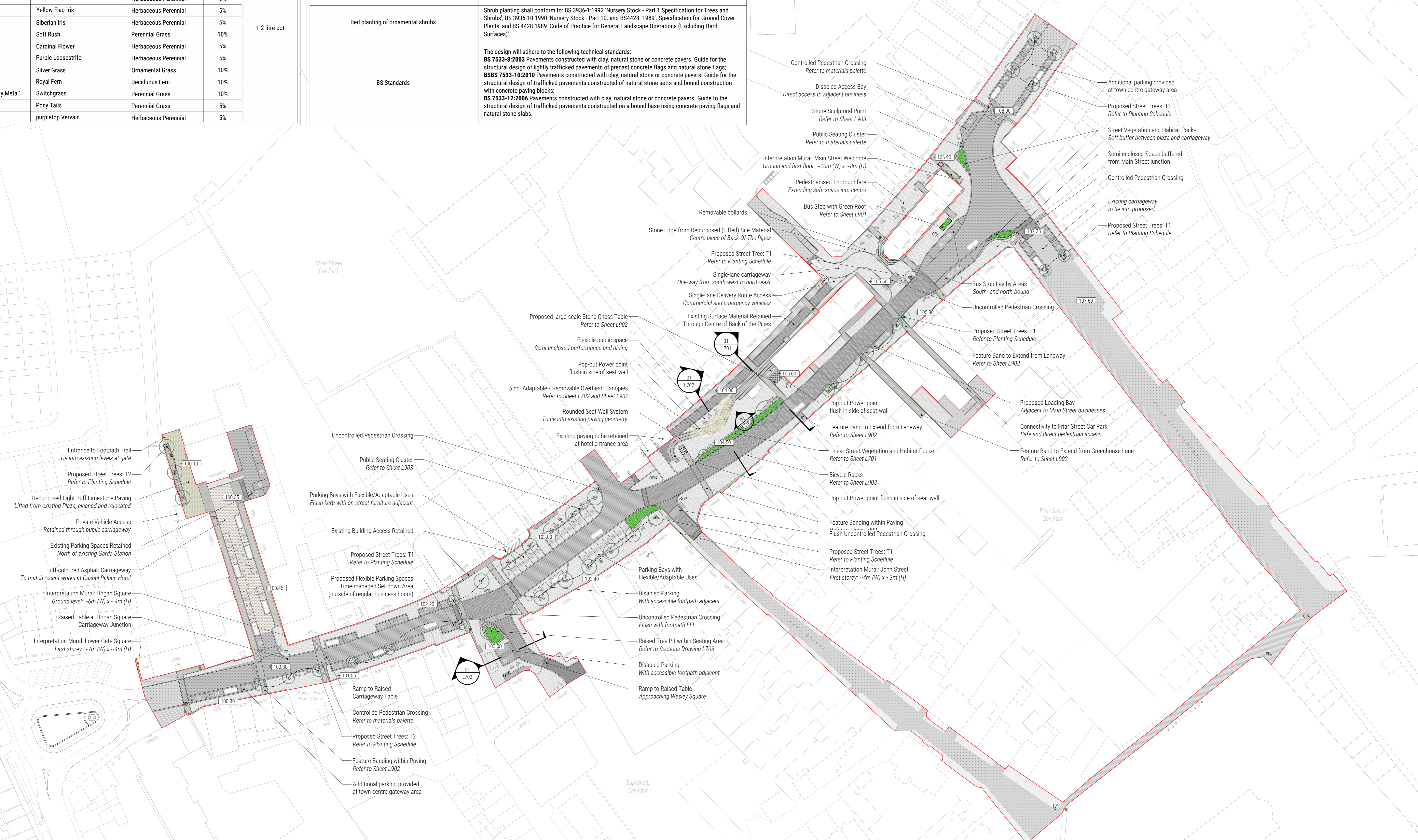

Proposed Planning Boundary
Public Realm Site Extents

Hardworks & Surfacing

- Paving 01: Raised Carriageway**
200mm (L) x 100mm (W) x 80mm (D)
mid-grey flamed granite;
Stretcher bond
- Paving 02: Primary Footpath**
600mm (L) x 300mm (W) x 60mm (D)
Silver grey granite, flamed;
Staggered stretcher bond
- Paving 03: Feature Band (A)**
600mm (L) x 300mm (W) x 60mm (D)
300mm (L) x 300mm (W) x 60mm (D)
150mm (L) x 300mm (W) x 60mm (D)
Brown shot-blasted granite mix;
Staggered stretcher bond
- Paving 04: Feature Band (B)**
100mm (L) x 100mm (W) x 100mm (D)
Brown shot-blasted granite cubes
Stacked (horizontal grid) bond
- Paving 05: Carriageway Ramp**
Stretcher bond through ramp centre:
200mm (L) x 100mm (W) x 80mm (D)
mid-grey flamed granite, stretcher bond;
Double stack at ramp top and bottom:
100mm (L) x 100mm (W) x 100mm (D)
mid-grey granite cube sets
- Paving 06: Feature Stone Edge**
Existing mid-grey stone edging
lifted from town Plaza steps and
re-laid at proposed fountain steps
- Paving 07: Feature Stone Edge**
Existing limestone paving,
lifted from access plaza, cleaned
and re-laid (new location)
- Paving 08: Asphalt Surface**
Proposed Carriageway Resurfacing

Kerbs & Edges

- Gridded Stone Set Edging**
100mm (L) x 100mm (W) x 100mm (D)
Brown shot-blasted granite cubes
Stacked (horizontal grid) bond
- Stone Seat Wall, Proposed**
Large unit mid-grey granite,
flame finish, unit dimensions to vary:
900mm (L) x 900 (W) x 50mm (D)
height varies across site slope
(maximum seat height 600mm)
- Tactile Paving, Blister**
400mm (L) x 400mm (W) x 50mm (D)
Red granite (controlled crossing)
Buff granite (uncontrolled crossing)
Blister finish, stacked (grid) pattern
- Tactile Paving, Corduroy**
400mm (L) x 400mm (W) x 50mm (D)
Sand-blasted blue-grey granite
Hazard paving, stacked (grid) pattern
- Raised Kerb, Proposed**
1000mm (L) x 300mm (W)
Sand-blasted dark grey granite
Refer to Sheet L703
- Flush Kerb, Proposed**
1000mm (L) x 300mm (W)
Sand-blasted dark grey granite
Refer to Sheet L703

Softworks & Vegetation

- Urban Habitat Pocket**
Groundcover / Herbaceous Mix
with Feature Elements for Local
Biodiversity and Interpretation
- Proposed Street Tree**
Refer to Plant Schedule for species
Refer to Sheet L903 for tree grille

Furniture & Details

- Seat Furniture Cluster**
Refer to Sheet L903
- Orientation Hub**
Refer to Sheet L903
- Orientation Point**
Refer to Sheet L903
- Interpretation Panel**
Refer to Sheet L903
- Interpretation Lectern**
Refer to Sheet L903
- Sculptural Point**
Refer to Sheet L903
- Street Light, Proposed**
Refer to Sheet L903
- Bicycle Parking, Proposed**
Refer to Sheet L903
- Overhead Canopy, Proposed**
Tensile Umbrella, Tulip-shaped
C1: 6m (Ø) x 3.70m (H) when open
C2: 5m (Ø) x 3.35m (H) when open
C3: 4m (Ø) x 3.35m (H) when open
Refer to Sheet L903
- Thomas Crook Cross**
Retained
- Interpretive Mural, Proposed**
Refer to annotation for indicative size
- Tree Pit and Grille, Proposed**
Refer to Furniture Details
- Litter Bin, Proposed**
Refer to Furniture Details
- Bus Shelter, Proposed**
To feature Green Roof System to
Augment Town Biodiversity Offering
Refer to Detail Sheet L901
- Bollard, Proposed**
Refer to Furniture Details
- Existing Phone Booth**
Retained in place

0 12.5 25 m
General Arrangement 1:500

Do not scale from drawing, use figured dimensions only.
All dimensions are to be checked on site by contractor prior to commencement of all work.
Discrepancies should be reported immediately.
This drawing is to be read in conjunction with all other TPC drawings and specifications.
The drawing is the copyright of the Landscape Architect and must not be reproduced or used
without permission.
Detailed information base information shown is reproduced from Ordnance Survey material ©
Crown copyright 2018. License Number 100049516.

Revision	Description	Date	Author
1	DRAFT PACKAGE FOR COORDINATION	03/06/2022	BD
A	DRAFT PACKAGE FOR REVIEW	13/06/2022	BD
B	DRAFT PACKAGE FOR REVIEW	28/06/2022	BD

thepaulhogarthcompany

LANDSCAPE ARCHITECTURE / URBAN DESIGN / PLANNING

01484 20131 331 4111 | 01484 20131 331 4111 | 01484 20131 331 4111 | 01484 20131 331 4111

15/04/2022 | BD | AM | 1:500

1431 | 1102 | A

TIPPERARY COUNTY COUNCIL
PUBLIC REALM ENHANCEMENT WORKS, CASHEL
GENERAL ARRANGEMENT PLAN
PLANNING