

Site Location
NTS

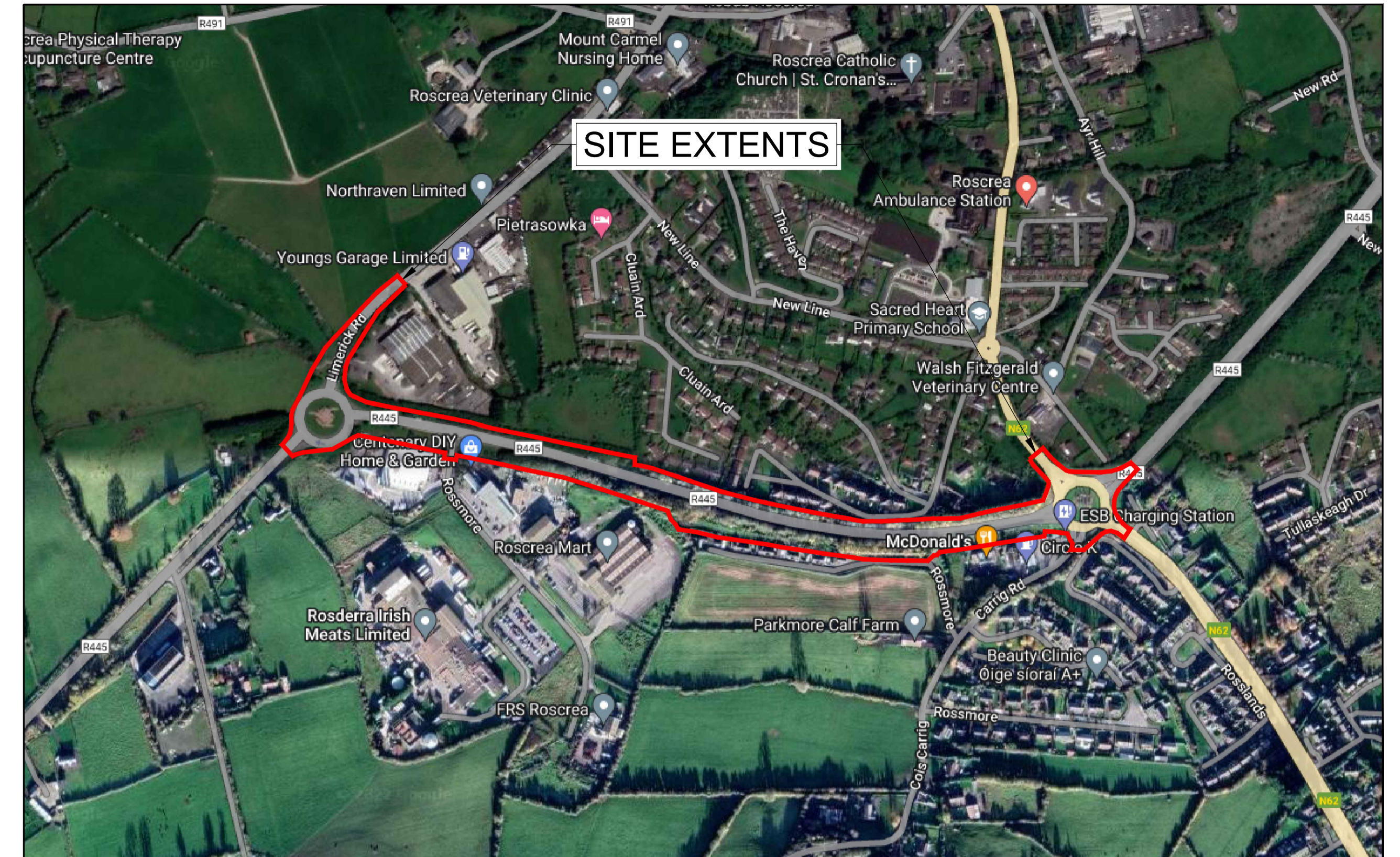

Site Location
NTS

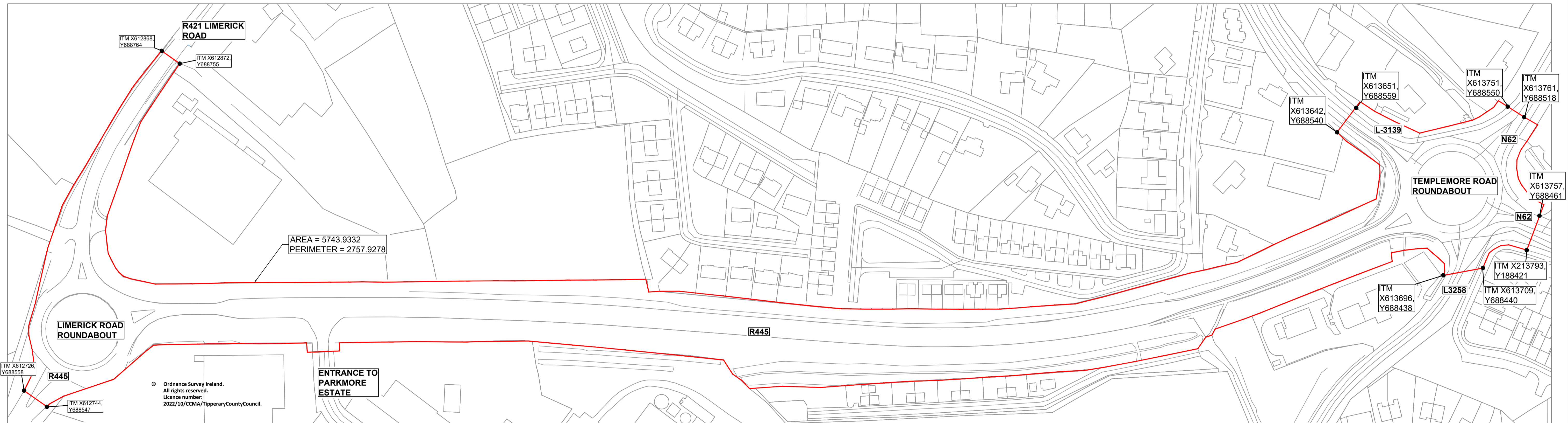

AREA PLAN
SCALE 1:2500



Tipperary County Council
Civic Offices, Clonmel | Civic Offices, Nenagh, Co. Tipperary



7 Ormonde Road, Kilkenny
Tel: +353(0)567795800
e-mail: info@roadplan.ie

LEGEND
— EXTENT OF SITE

DRAFT 4

No.	Revision	Date	By	Chk'd	App'd
Designed:	JMC	Checked:	GF	Approved:	DD

Project Title: R445 FOOTWAY & CYCLEWAY SCHEME, ROSCREA			
Drawing Title: SITE LOCATION			
Drawn by:	JMC	Sheet Size:	A1
Scale:	As Shown	Date:	Jan '22
Drawing Number:	20128-01-0001		Revision: Draft 4

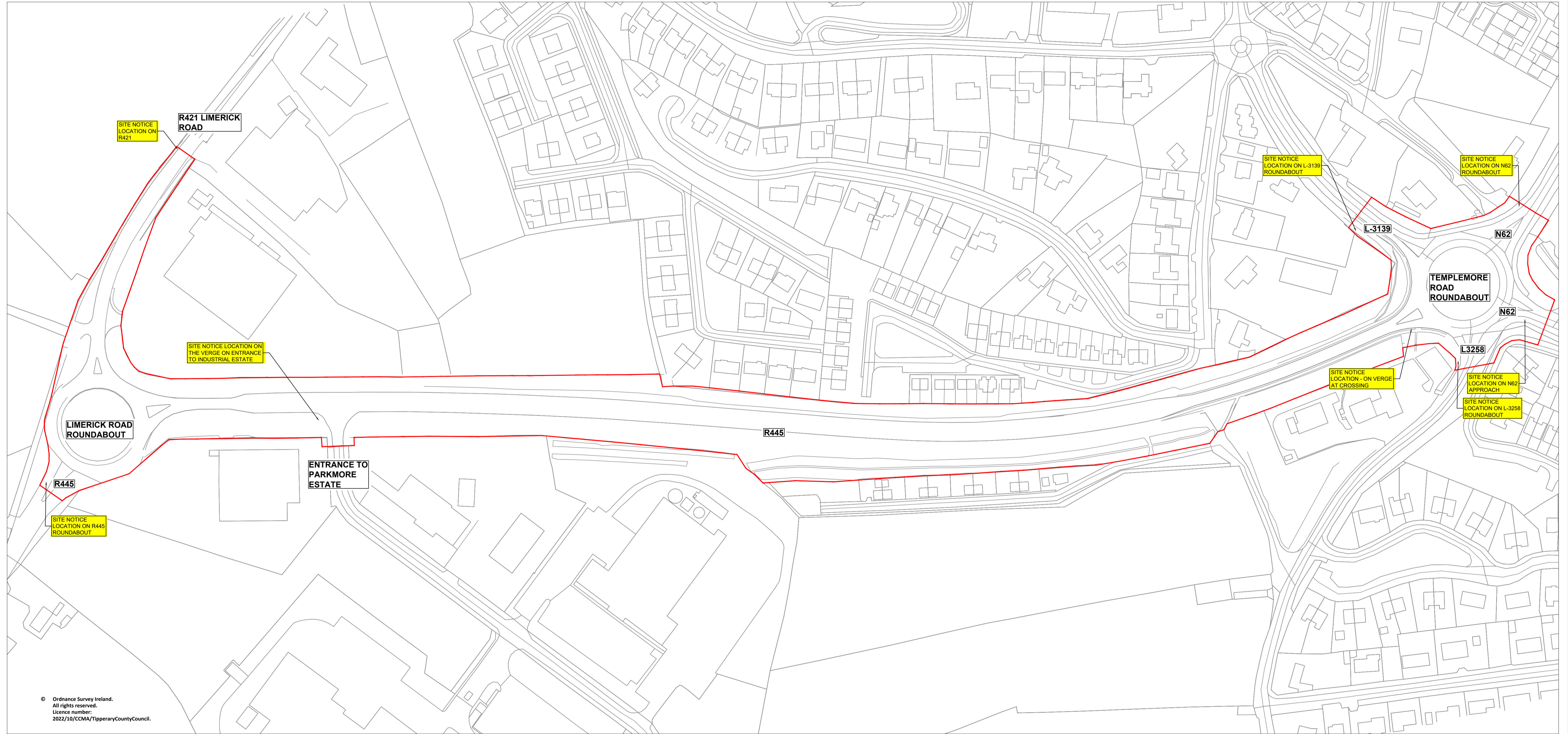

© Ordnance Survey Ireland.
All rights reserved.
Licence number:
2022/10/CCMA/TipperaryCountyCouncil.

LEGEND

— EXTENT OF SITE

DRAFT 3

Project Title: **R445 FOOTWAY & CYCLEWAY SCHEME, ROSCREA**

Drawing Title: **SITE NOTICE LOCATIONS**

Drawn by: **JMC** Sheet Size: **A3** Scale: **1:2500** Date: **Jan '22**

Drawing Number: **20128-01-0002** Revision: **Draft 3**



Tipperary County Council
Civic Offices, Clonmel | Civic
Offices, Nenagh,
Co. Tipperary



7 Ormonde Road,
Kilkenny
Tel: +353(0)567795800
e-mail: info@roadplan.ie

No.	Revision	Date	By	Chk'd	App'd
Designed:	JMC	Checked:	GF	Approved:	DD