

**Legend**

- Proposed Site Boundary
- Folio Boundary

Land Folio	CPO Area Required
Not Registered 01	15413m <sup>2</sup>
TY27823	1463m <sup>2</sup>
TY27848	3592m <sup>2</sup>
TY18396	3078m <sup>2</sup>
Not Registered 02	32m <sup>2</sup>
TY51557F	421m <sup>2</sup>

- Land Folio for CPO-Folio TY27848 3,182m<sup>2</sup> required for CPO
- Land Folio for CPO-Folio TY18396 3,078m<sup>2</sup> required for CPO
- Land Folio for CPO-Land not Registered 01 15,413m<sup>2</sup> required for CPO
- Land Folio for CPO-Folio TY27823 1,463m<sup>2</sup> required for CPO
- Land Folio for CPO-Land not Registered 02 32m<sup>2</sup> required for CPO
- Land Folio for CPO-Folio TY27848 410m<sup>2</sup> required for Temporary Acquisition for Construction Works.
- Land Folio for CPO-Folio TY51557F 421m<sup>2</sup> required for Temporary Acquisition for Construction Works.



**TIPPERARY TOWN CLOSED LANDFILL REMEDIATION SCHEME  
COMPULSORY PURCHASE ORDER (ENVIRONMENT) 2023**

Dated the 2<sup>nd</sup> day of APRIL 2023.  
Present when the Official Seal of Tipperary County Council:

*[Signature]* Chief Executive  
*[Signature]* Director of Services

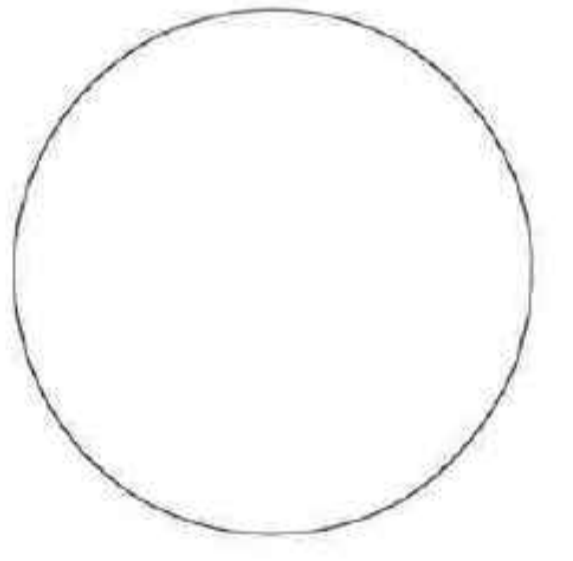

**Note:**  
This Deposit map is a copy of the original

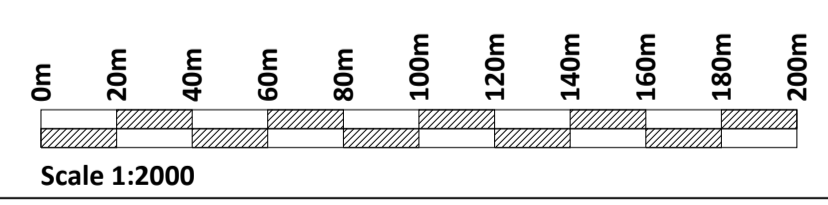

© 2020 Microsoft Corporation © 2020 Maxar ©CNES (2020) Distribution Airbus DS

If Applicable : Ordnance Survey Ireland Licence No. EN 0001220 © Ordnance Survey Ireland and Government of Ireland OSI - 5116C



No part of this document may be reproduced or transmitted in any form or stored in any retrieval system of any nature without the written permission of Fehily Timoney & Company as copyright holder except as agreed for use on the project for which the document was originally issued. Do not scale. Use figured dimensions only. If in doubt - Ask!

Rev.	Description	App By	Date
A	ISSUE FOR PLANNING	BG	17.11.21
B	ISSUE FOR PLANNING	CJC	27.09.22

<b>PROJECT</b>	<b>TIPPERARY TOWN HISTORIC LANDFILL REMEDIATION</b>
<b>SHEET</b>	<b>Tipperary Town Closed Landfill Remediation Scheme, CPO of Portions of Land from Folios TY27848, TY18396, TY27823 and lands Not Registered 1 &amp; 2 Situated in the Townland of Carrownreddy &amp; Spital-Land, Co. Tipperary.</b>

<b>CLIENT</b>	<b>TIPPERARY COUNTY COUNCIL</b>		
Date	17.11.21	Project number	P0563
Drawn by	SOC	Drawing Number	P0563-CPO-0000
Checked by	AB	Scale (@ A1-)	1:2000
		Rev	<b>B</b>

O:\ACAD\2018\0563\0563-CPO-0000

02 May 2023

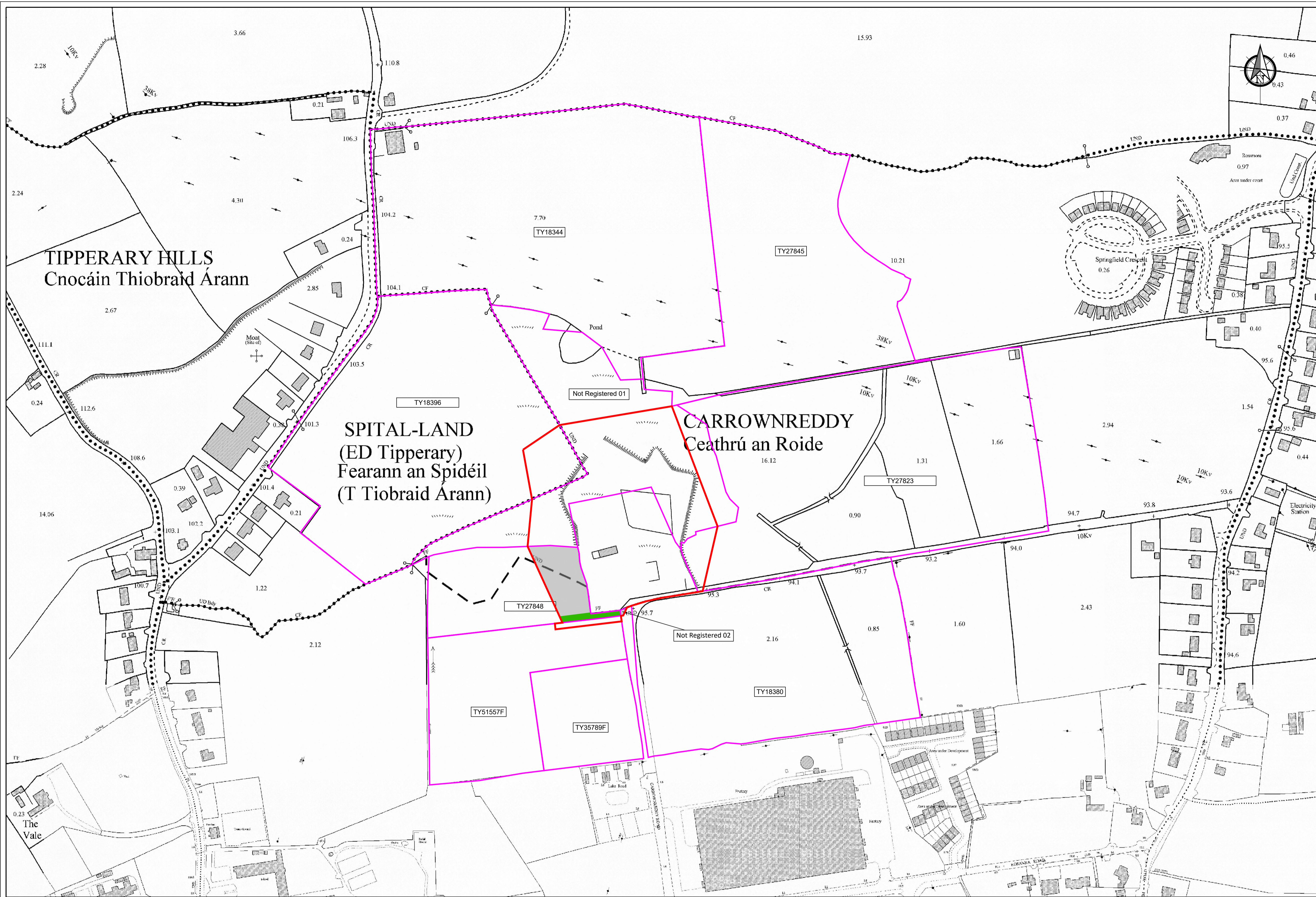

- Legend**
- Proposed Site Boundary
  - Folio Boundary
  - Land Folio for CPO-Folio TY27848 3,182m<sup>2</sup> required for CPO
  - Land Folio for CPO-Folio TY27848 410m<sup>2</sup> required for Temporary Acquisition for Construction Works.



**TIPPERARY TOWN CLOSED LANDFILL REMEDIATION SCHEME  
COMPULSORY PURCHASE ORDER (ENVIRONMENT) 2023**

Dated the 2<sup>nd</sup> day of APRIL 2023.

Present when the Official Seal of Tipperary County Council:

*[Signature]* Chief Executive  
*[Signature]* Director of Services

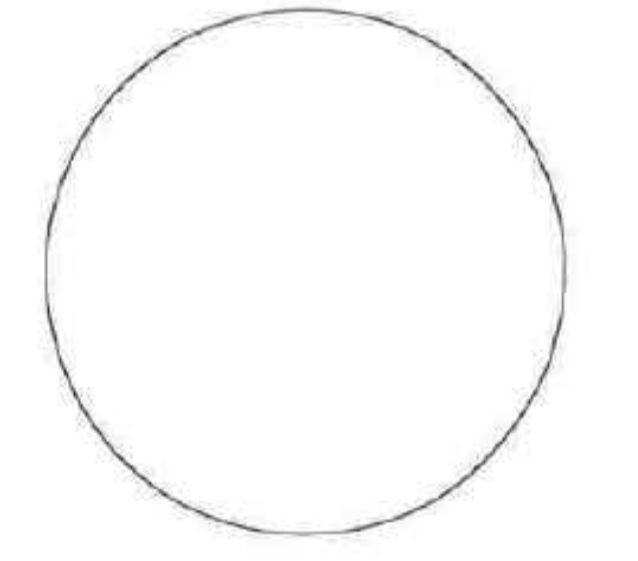

**Note:**  
This Deposit map is a copy of the original

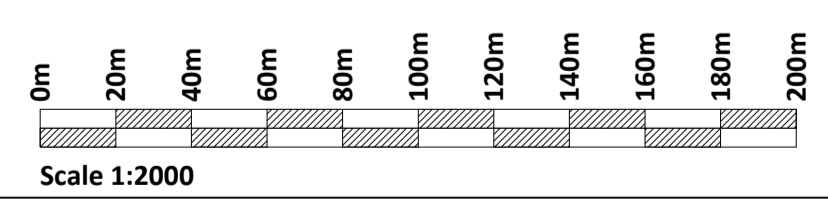

If Applicable : Ordnance Survey Ireland Licence No. EN 0001220 © Ordnance Survey Ireland and Government of Ireland OSI - 5116C



No part of this document may be reproduced or transmitted in any form or stored in any retrieval system of any nature without the written permission of Fehily Timoney & Company as copyright holder except as agreed for use on the project for which the document was originally issued. Do not scale. Use figured dimensions only. If in doubt - Ask!

Rev.	Description	App By	Date
A	ISSUE FOR PLANNING	CJC	17.11.21
B	ISSUE FOR PLANNING	CJC	07.12.21
C	ISSUE FOR PLANNING	CJC	21.06.22
D	ISSUE FOR PLANNING	CJC	27.09.22

<b>PROJECT</b>	<b>TIPPERARY TOWN HISTORIC LANDFILL REMEDIATION</b>
<b>SHEET</b>	<b>Tipperary Town Closed Landfill Remediation Scheme, CPO of Portion of Lands from Folio TY27848 Situated in the Townland of Carrownreddy, Co. Tipperary.</b>

<b>CLIENT</b>			
<b>TIPPERARY COUNTY COUNCIL</b>			
Date	17.11.21	Project number	P0563
Drawn by	CS	Drawing Number	P0563-CPO-0001
Checked by	AB	Scale (@ A1-)	1:2000
		Rev	<b>D</b>

O:\ACAD\2018\P0563\P0563-CPO-0001

02 May 2023

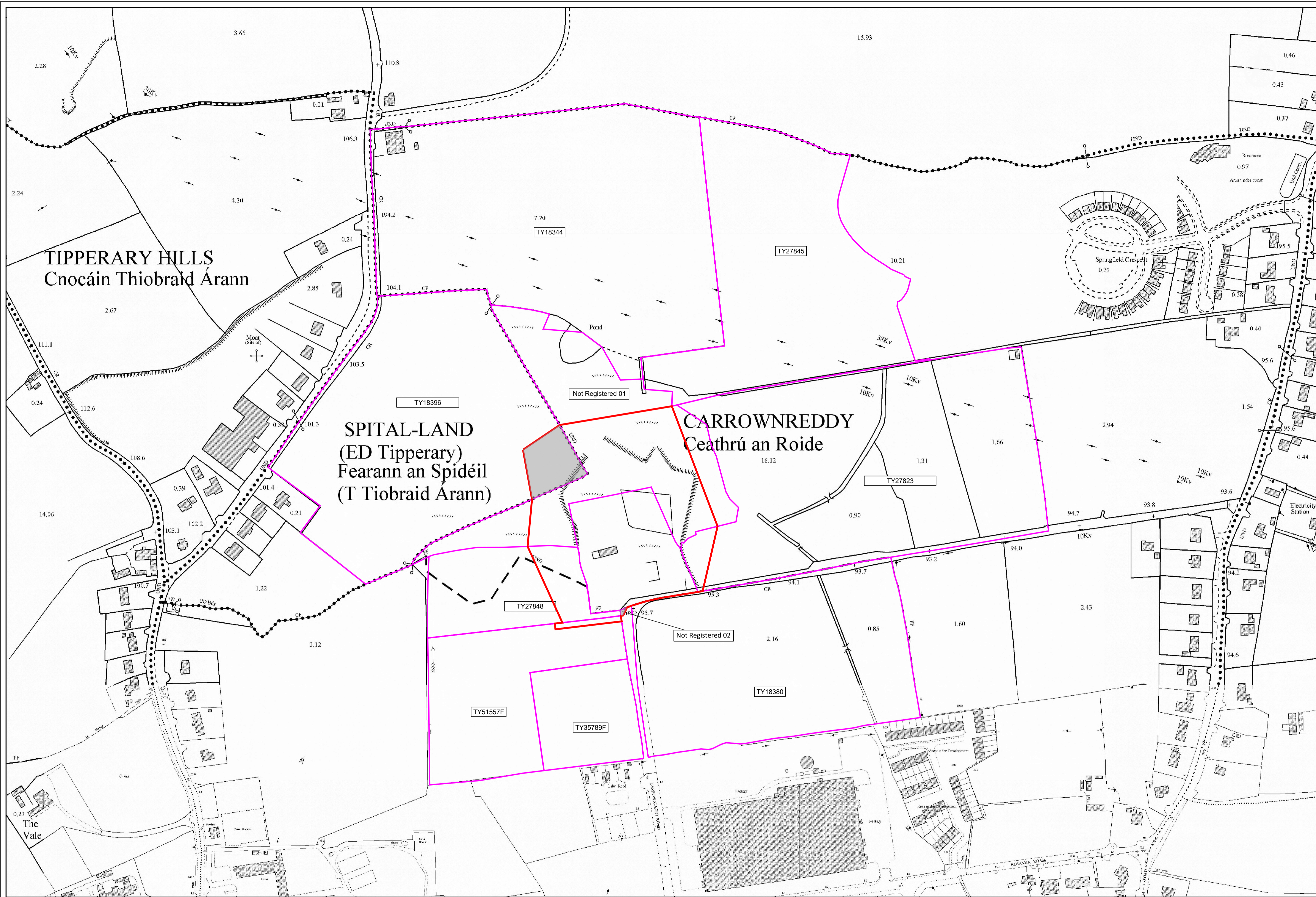

- Legend**
- Proposed Site Boundary
  - Folio Boundary
  - Land Folio for CPO-Folio TY18396  
3,078m<sup>2</sup> required for CPO



**TIPPERARY TOWN CLOSED LANDFILL  
REMEDATION SCHEME  
COMPULSORY PURCHASE ORDER  
(ENVIRONMENT) 2023**

Dated the 21<sup>st</sup> day of APRIL  
2023.  
Present when the Official Seal of Tipperary County  
Council:

*[Signature]* Chief Executive  
*[Signature]* Director of Services

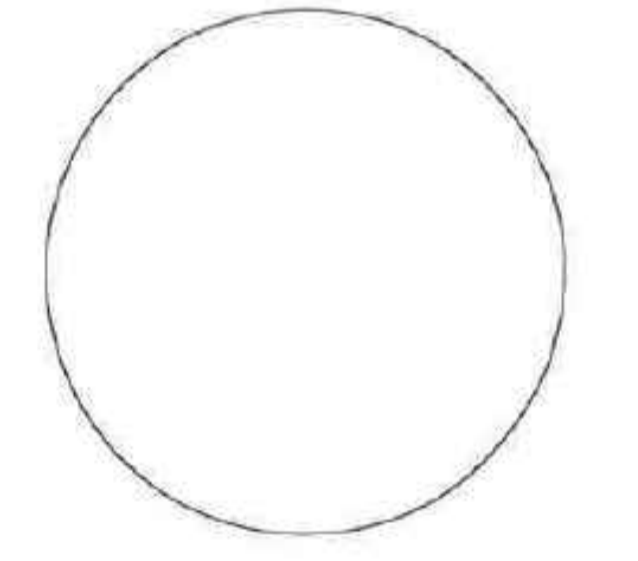

**Note:**  
This Deposit map is a copy of the original

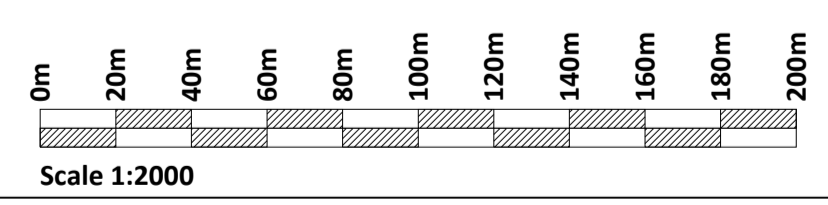

If Applicable : Ordnance Survey Ireland Licence No. EN 0001220 © Ordnance Survey Ireland and Government of Ireland  
OSI - 5116C



No part of this document may be reproduced or transmitted in any form or stored in any retrieval system of any nature without the written permission of Fehily Timoney & Company as copyright holder except as agreed for use on the project for which the document was originally issued. Do not scale. Use figured dimensions only. If in doubt - Ask!

Rev.	Description	App By	Date
A	ISSUE FOR PLANNING	CJC	17.11.21
B	ISSUE FOR PLANNING	CJC	07.12.21
C	ISSUE FOR PLANNING	CJC	27.09.22

<b>PROJECT</b>	<b>TIPPERARY TOWN HISTORIC LANDFILL REMEDATION</b>
<b>SHEET</b>	<b>Tipperary Town Closed Landfill Remediation Scheme, CPO of Portion of Land from Folio TY18396 situated in the townland of Spital-Land, Co. Tipperary</b>

<b>CLIENT</b>			
<b>TIPPERARY COUNTY COUNCIL</b>			
Date	17.11.21	Project number	P0563
Drawn by	CS	Drawing Number	P0563-CPO-0002
Checked by	AB	Scale (@ A1-)	1:2000
		Rev	<b>C</b>

O:\ACAD\2018\P0563\P0563-CPO-0002

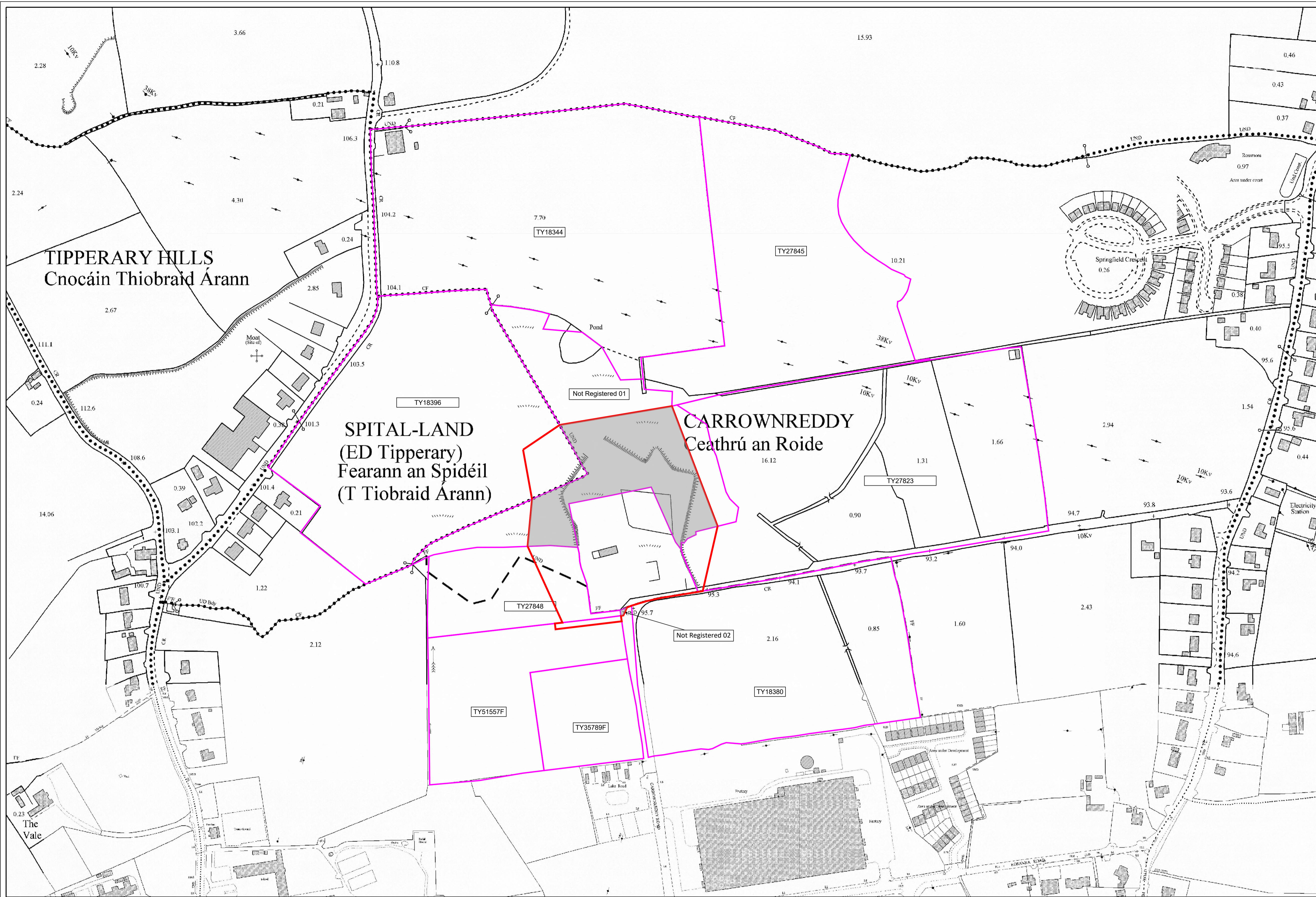

- Legend**
- Proposed Site Boundary
  - Folio Boundary
  - Land Folio for CPO-Land not Registered 01  
15,413m<sup>2</sup> required for CPO



**TIPPERARY TOWN CLOSED LANDFILL  
REMEDIATION SCHEME  
COMPULSORY PURCHASE ORDER  
(ENVIRONMENT) 2023**

Dated the 21<sup>st</sup> day of April  
2023.

Present when the Official Seal of Tipperary County Council:

*[Signature]* Chief Executive  
*[Signature]* Director of Services

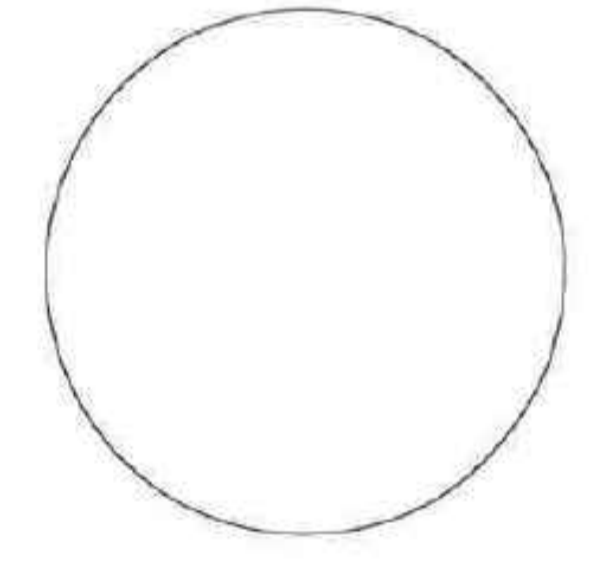

**Note:**  
This Deposit map is a copy of the original

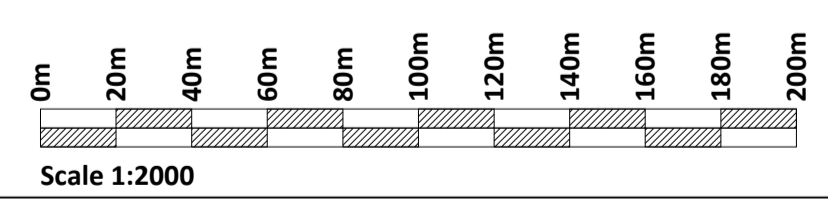

If Applicable : Ordnance Survey Ireland Licence No. EN 0001220 © Ordnance Survey Ireland and Government of Ireland OSI - 5116C



No part of this document may be reproduced or transmitted in any form or stored in any retrieval system of any nature without the written permission of Fehily Timoney & Company as copyright holder except as agreed for use on the project for which the document was originally issued. Do not scale. Use figured dimensions only. If in doubt - Ask!

Rev.	Description	App By	Date
A	ISSUE FOR PLANNING	CJC	17.11.21
B	ISSUE FOR PLANNING	CJC	07.12.21
C	ISSUE FOR PLANNING	CJC	27.09.22

<b>PROJECT</b>	<b>TIPPERARY TOWN HISTORIC LANDFILL REMEDIATION</b>
<b>SHEET</b>	<b>Tipperary Town Closed Landfill Remediation Scheme, CPO of portion of land from Lands not Registered 01 situated in the townland of Carrownreddy, Co. Tipperary</b>

<b>CLIENT</b>			
<b>TIPPERARY COUNTY COUNCIL</b>			
Date	17.11.21	Project number	P0563
Drawn by	CS	Drawing Number	P0563-CPO-0003
Checked by	AB	Scale (@ A1-)	1:2000
		Rev	<b>C</b>

O:\ACAD\2018\0563\0563-CPO-0003

02 May 2023

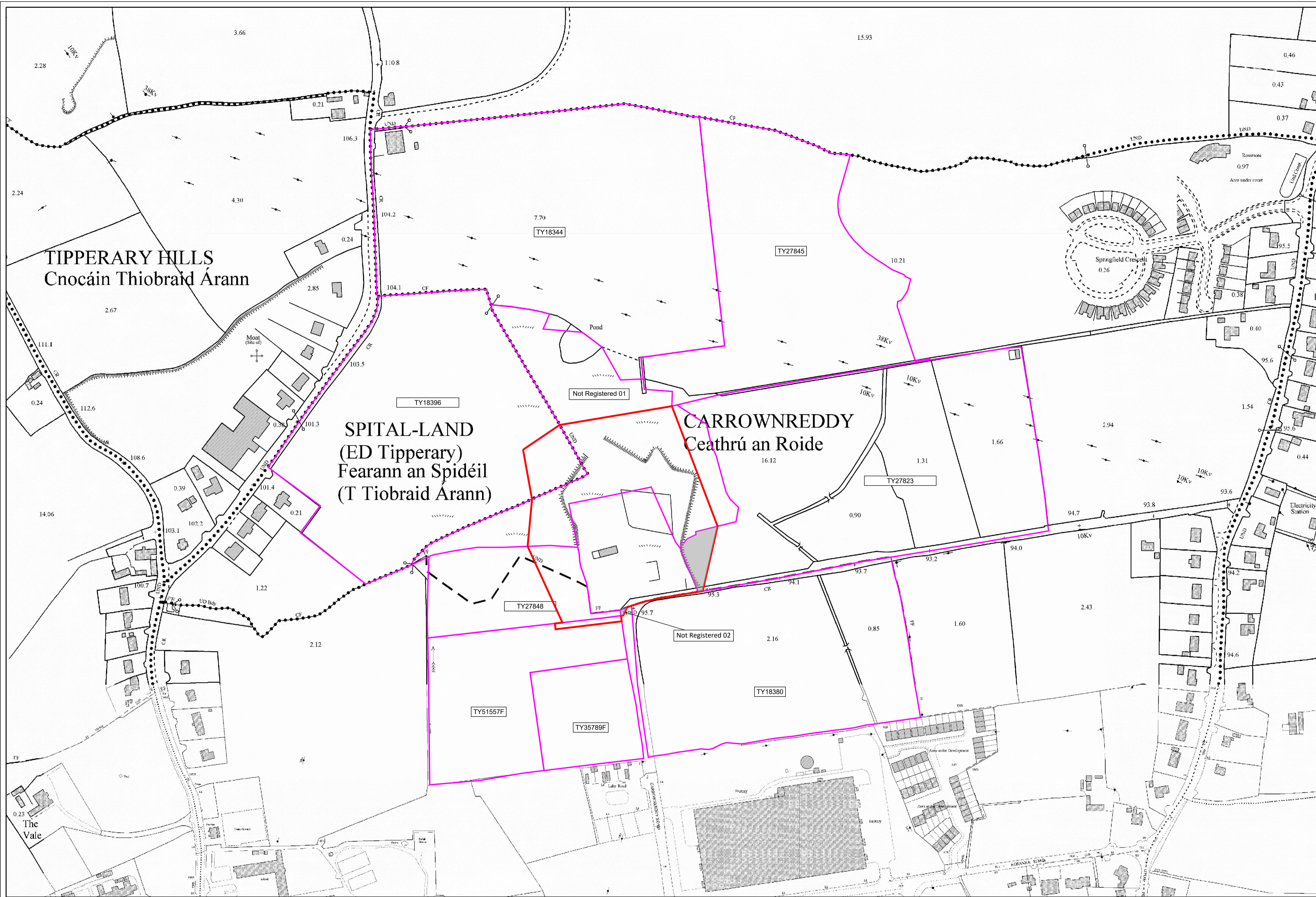

- Legend**
- Proposed Site Boundary
  - Folio Boundary
  - Land Folio for CPO-Folio TY27823  
1,463m² required for CPO



**TIPPERARY TOWN CLOSED LANDFILL  
REMEDATION SCHEME  
COMPULSORY PURCHASE ORDER  
(ENVIRONMENT) 2023**

Dated the 21<sup>st</sup> day of April  
2023.

Present when the Official Seal of Tipperary County Council:

*[Signature]* Chief Executive  
*[Signature]* Director of Services

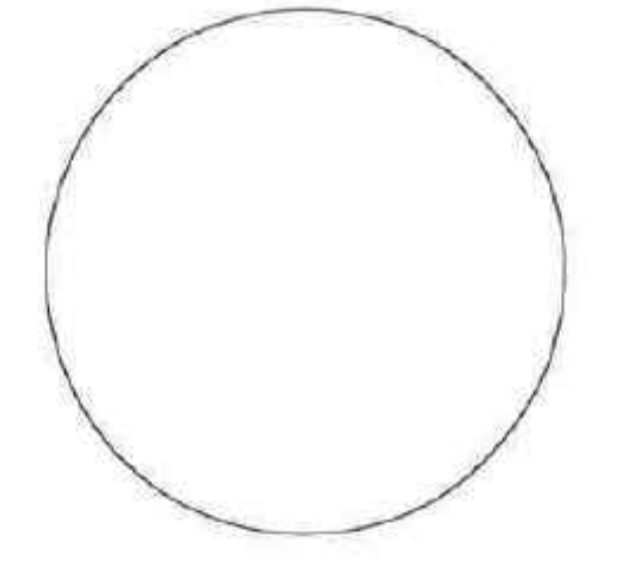

**Note:**  
This Deposit map is a copy of the original

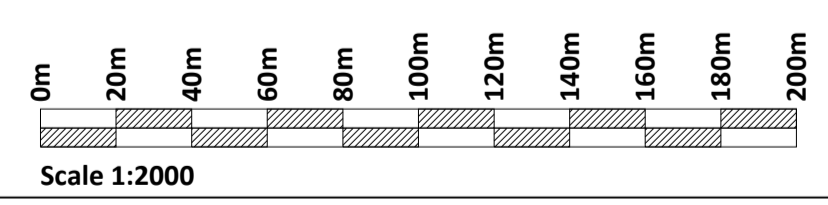

If Applicable : Ordnance Survey Ireland Licence No. EN 0001220 © Ordnance Survey Ireland and Government of Ireland OSI - 5116C



No part of this document may be reproduced or transmitted in any form or stored in any retrieval system of any nature without the written permission of Fehily Timoney & Company as copyright holder except as agreed for use on the project for which the document was originally issued. Do not scale. Use figured dimensions only. If in doubt - Ask!

Rev.	Description	App By	Date
A	ISSUE FOR PLANNING	CJC	17.11.21
B	ISSUE FOR PLANNING	CJC	07.12.21
C	ISSUE FOR PLANNING	CJC	27.09.22

<b>PROJECT</b>	<b>TIPPERARY TOWN HISTORIC LANDFILL REMEDATION</b>
<b>SHEET</b>	<b>Tipperary Town Closed Landfill Remediation Scheme, CPO of portion of land from Folio TY27823 situated in the townland of Carrownreddy, Co. Tipperary</b>

<b>CLIENT</b>			
<b>TIPPERARY COUNTY COUNCIL</b>			
Date	17.11.21	Project number	P0563
Drawn by	CS	Drawing Number	P0563-CPO-0004
Checked by	AB	Scale (@ A1-)	1:2000
		Rev	<b>C</b>

O:\ACAD\2018\P0563\P0563-CPO-0004

02 May 2023

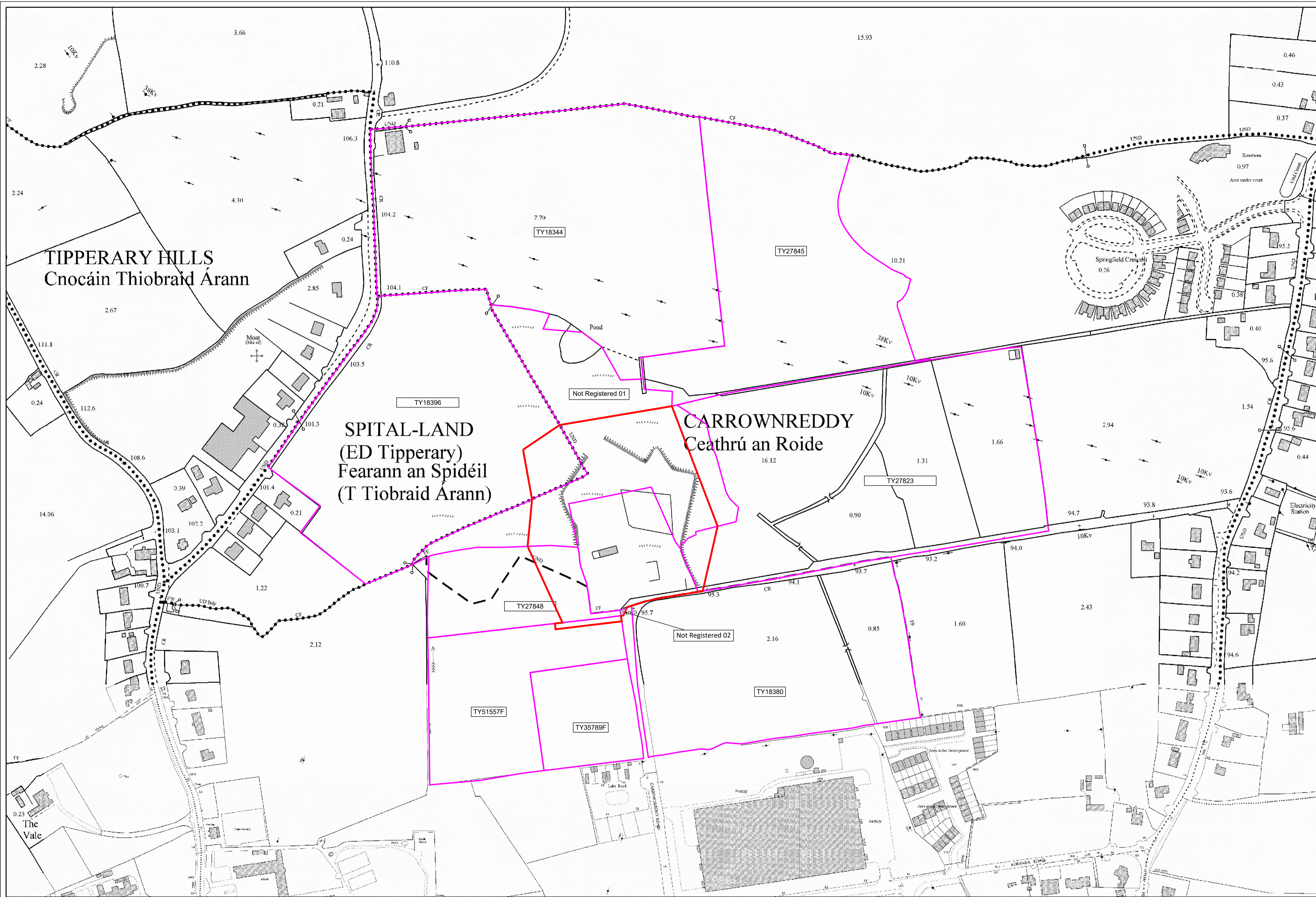

- Legend**
- Proposed Site Boundary
  - Folio Boundary
  - Land Folio for CPO-Land not Registered 02 32m² required for CPO



**TIPPERARY TOWN CLOSED LANDFILL  
REMEDIATION SCHEME  
COMPULSORY PURCHASE ORDER  
(ENVIRONMENT) 2023**

Dated the 21<sup>st</sup> day of April 2023.

Present when the Official Seal of Tipperary County Council:

*[Signature]* Chief Executive  
*[Signature]* Director of Services

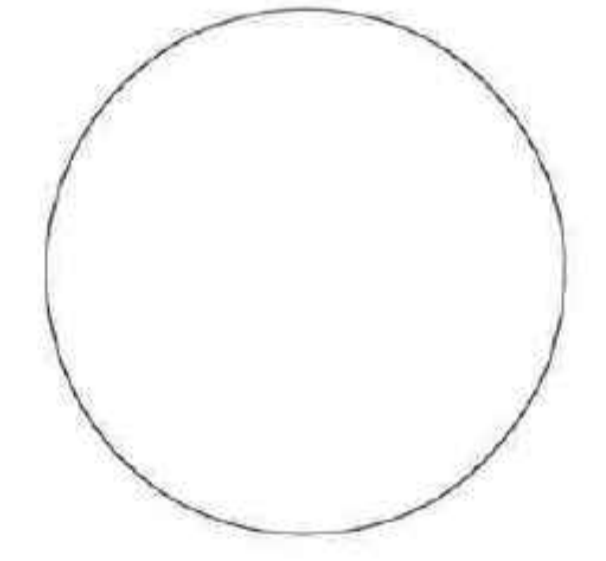

**Note:**  
This Deposit map is a copy of the original

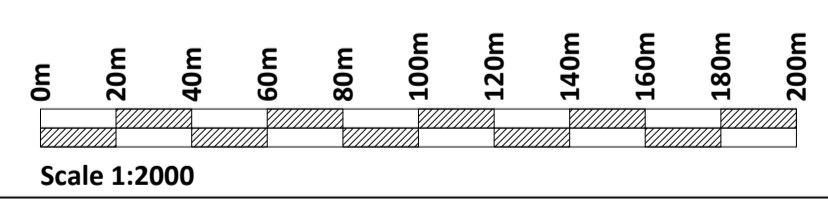

If Applicable : Ordnance Survey Ireland Licence No. EN 0001220 © Ordnance Survey Ireland and Government of Ireland OSI - 5116C



No part of this document may be reproduced or transmitted in any form or stored in any retrieval system of any nature without the written permission of Fehily Timoney & Company as copyright holder except as agreed for use on the project for which the document was originally issued. Do not scale. Use figured dimensions only. If in doubt - Ask!

Rev.	Description	App By	Date
A	ISSUE FOR PLANNING	CJC	11.08.20
B	ISSUE FOR PLANNING	CJC	07.12.21
C	ISSUE FOR PLANNING	CJC	27.09.22

<b>PROJECT</b>	<b>TIPPERARY TOWN HISTORIC LANDFILL REMEDIATION</b>
<b>SHEET</b>	<b>Tipperary Town Closed Landfill Remediation Scheme, CPO of portion of land from Lands not Registered 02 situated in the townland of Carrownreddy, Co. Tipperary</b>

<b>CLIENT</b>			
<b>TIPPERARY COUNTY COUNCIL</b>			
Date	11.08.20	Project number	P0563
Drawn by	SOC	Drawing Number	P0563-CPO-0005
Checked by	AB	Scale (@ A1-)	1:2000
		Rev	<b>C</b>

O:\ACAD\2018\0563\0563-CPO-0005

02 May 2023

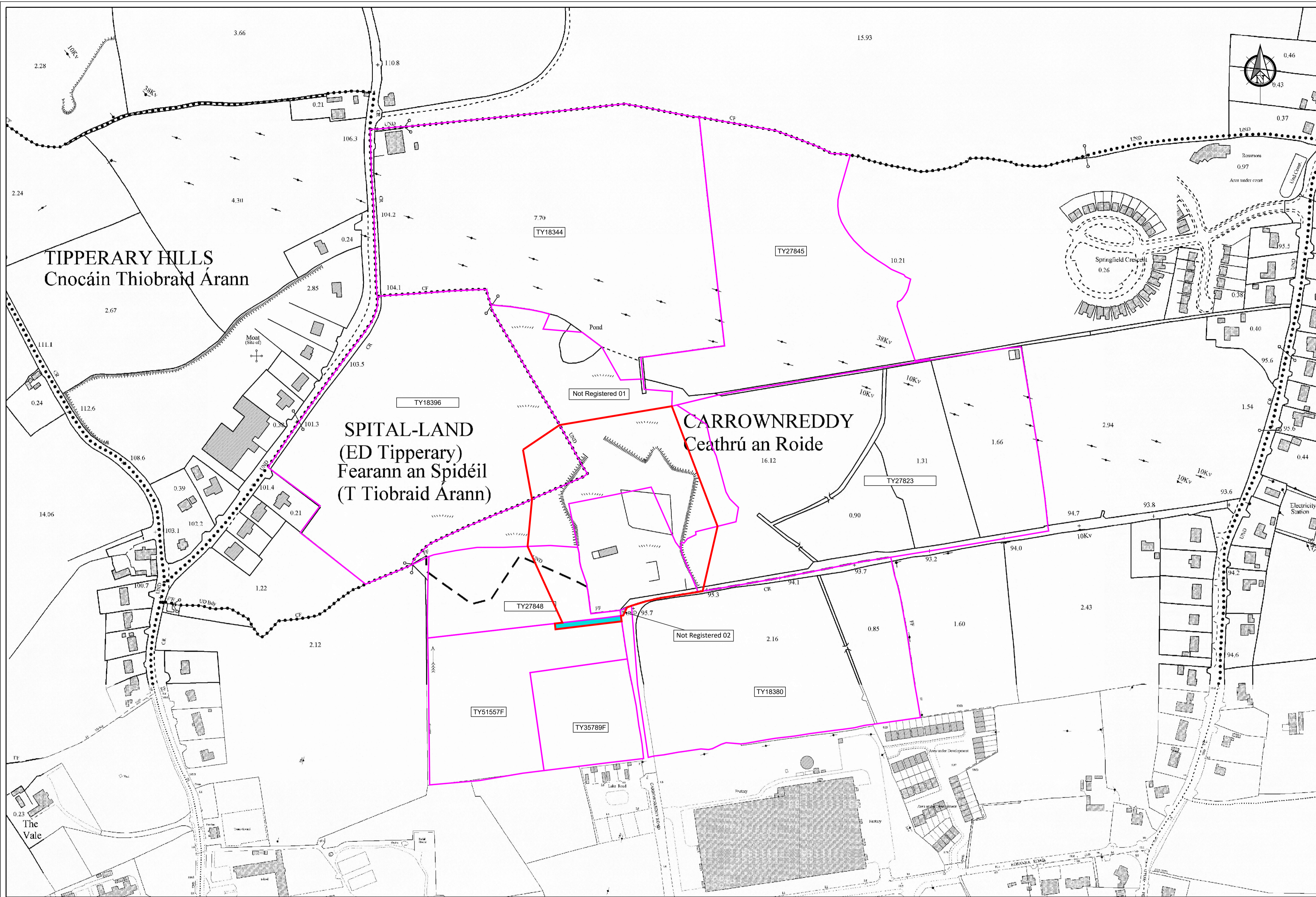

- Legend**
- Proposed Site Boundary
  - Folio Boundary
  - Land Folio for CPO-Folio TY51557F 421m<sup>2</sup> required for Temporary Acquisition for Construction Works.



**TIPPERARY TOWN CLOSED LANDFILL  
REMEDATION SCHEME  
COMPULSORY PURCHASE ORDER  
(ENVIRONMENT) 2023**

Dated the 27<sup>th</sup> day of April  
2023.  
Present when the Official Seal of Tipperary County  
Council:

*[Signature]* Chief Executive  
*[Signature]* Director of Services

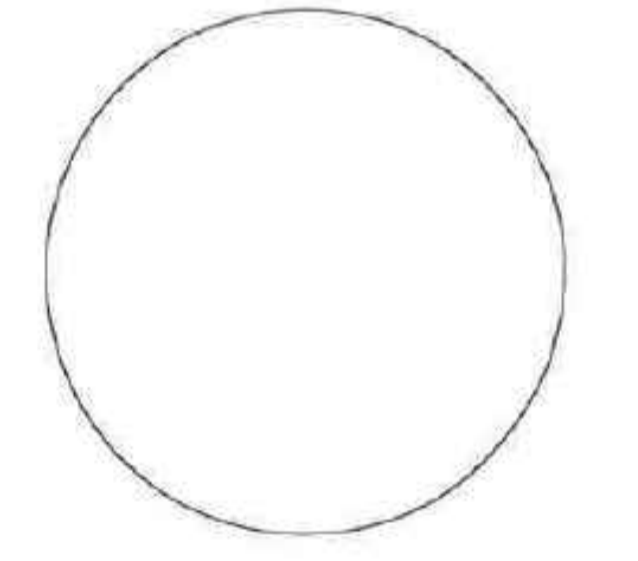

**Note:**  
This Deposit map is a copy of the original

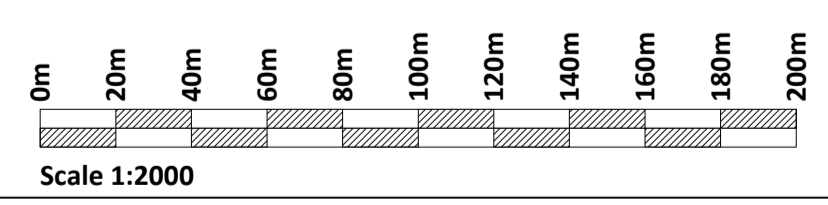

If Applicable : Ordnance Survey Ireland Licence No. EN 0001220 © Ordnance Survey Ireland and Government of Ireland OSI - 5116C



No part of this document may be reproduced or transmitted in any form or stored in any retrieval system of any nature without the written permission of Fehily Timoney & Company as copyright holder except as agreed for use on the project for which the document was originally issued. Do not scale. Use figured dimensions only. If in doubt - Ask!

Rev.	Description	App By	Date
A	ISSUE FOR PLANNING	CJC	27.09.22

<b>PROJECT</b>	<b>TIPPERARY TOWN HISTORIC LANDFILL REMEDATION</b>
<b>SHEET</b>	<b>Tipperary Town Closed Landfill Remediation Scheme, CPO of portion of lands from Folio TY51557F situated in the townland of Carrownreddy, Co. Tipperary</b>

<b>CLIENT</b>			
<b>TIPPERARY COUNTY COUNCIL</b>			
Date	27.09.22	Project number	P0563
Drawn by	CS	Drawing Number	P0563-CPO-0006
Checked by	RD	Scale (@ A1-)	1:2000
		Rev	<b>A</b>

O:\ACAD\2018\P0563\P0563-CPO-0006