

► Submission information

Site Reference No.

TYLA00005355

Site Address (if known). Note: map can be uploaded as supporting documentation below

Shesheraghkeale, Nenagh. Folio no. TY39183. O.S. Reference 585248 / 678813

Your Status

Third Party

Requested action

Exclusion

Details of Submission Request

I wish to apply to exclude site Folio TY39183 from the RZLT maps. This small site of 0.107 hectares was acquired c. 1970 and is directly adjacent to the site of the current family home. The site was inherited by the current owner Mrs Dolores Maher upon the death of her husband last May 2023. There is an opening (driveway/walkway) connecting the two sites which was always and continues to be used to access the garden and sheds that are on it and which are considered to be part of the main residence. These sheds are specifically used for domestic purposes eg to store fuel, garden equipment etc for the adjoining residence and garden of

the family home.

Please see attached 3 photos along with a map of the site.

Supporting documentation

- [Map Folio 39183.docx](#) (479.63 KB)
- [Photos Folio 39183.docx](#) (1.95 MB)

Full Name

Eoin Maher

Email Address

[REDACTED]

Phone Number

[REDACTED]

Address

7 Talbot's Grove,
Freshford road,
Kilkenny

Eircode

R95K7N1

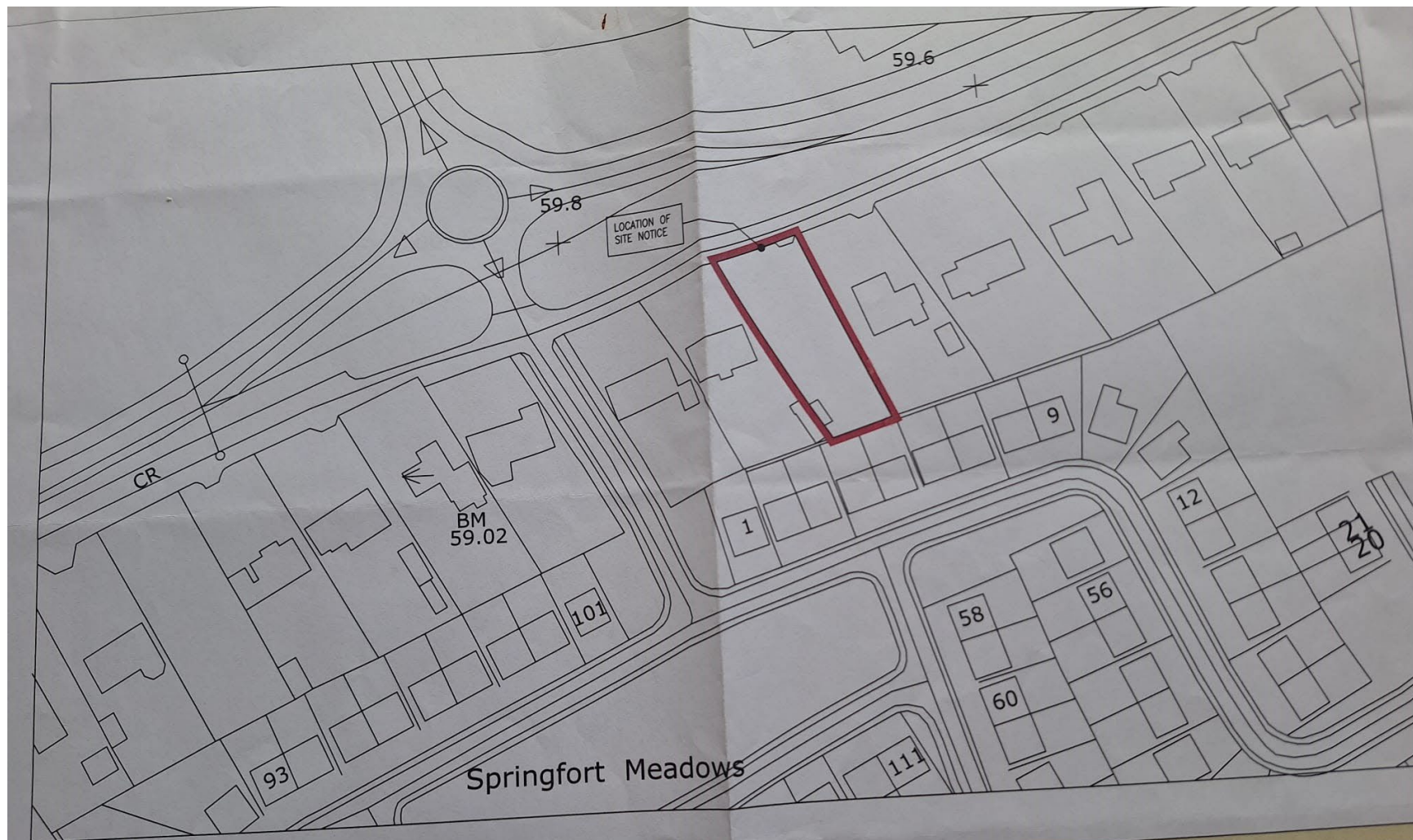

SITE LOCATION MAP
 TOWNSLAND: SHESHERAGHKEALE, LIMERICK ROAD,
 NENAGH, CO TIPPERARY
 SCALE 1:1000
 O.S. REFERENCE 585248 / 678813
 SITE AREA : 0.107 HA
 (C) ORDNANCE SURVEY IRELAND LICENCE NUMBER AR 0057613





John Joe Lewis Architectural
 No.4 Silver View, Nenagh, Co Tipperary

| | |
|-----------------|--|
| Title: | SITE LOCATION MAP |
| Client: | TIM MAHER SHESHERAGHKEALE, LMK RD |
| Project: | PROPOSED DEVELOPMENT AT SHESHERAGHKEALE, LMK RD |

Tel: 087 2415300 / 067 34906 E.mail: johnjoe



