

CLIENT  
 Comhairle Contae Thibraid Árann  
 Tipperary County Council

ARCHITECTS  
 dhbarchitects  
 ARCHITECTS

ARCHAEOLOGISTS  
 CourtneyDeery  
 ARCHAEOLOGY & CULTURAL HERITAGE

BRIDGES  
 MARC MIMRAM  
 ARCHITECTURE  
 INGÉNIÉRIE

ENGINEERS  
 Clifton Scannell Emerson  
 Associates

ENVIRONMENTAL CONSULTANTS  
 awnconsulting  
 A Trinity Consultants Company

ENGINEERS  
 Clifton Scannell Emerson  
 Associates

LIGHTING CONSULTANTS  
 Douglas Carroll  
 Consulting Engineers

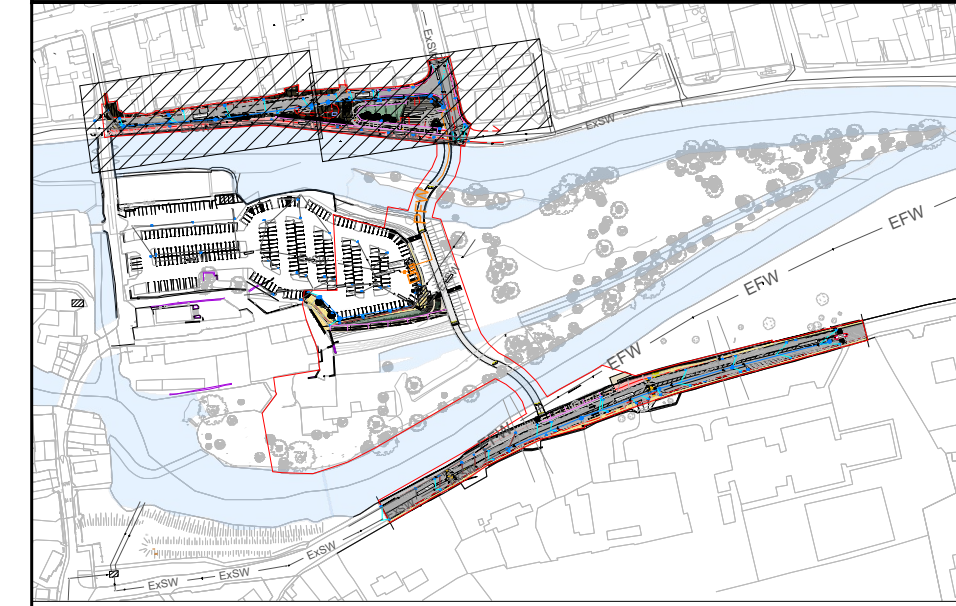

KEYPLAN  
 SCALE N.T.S

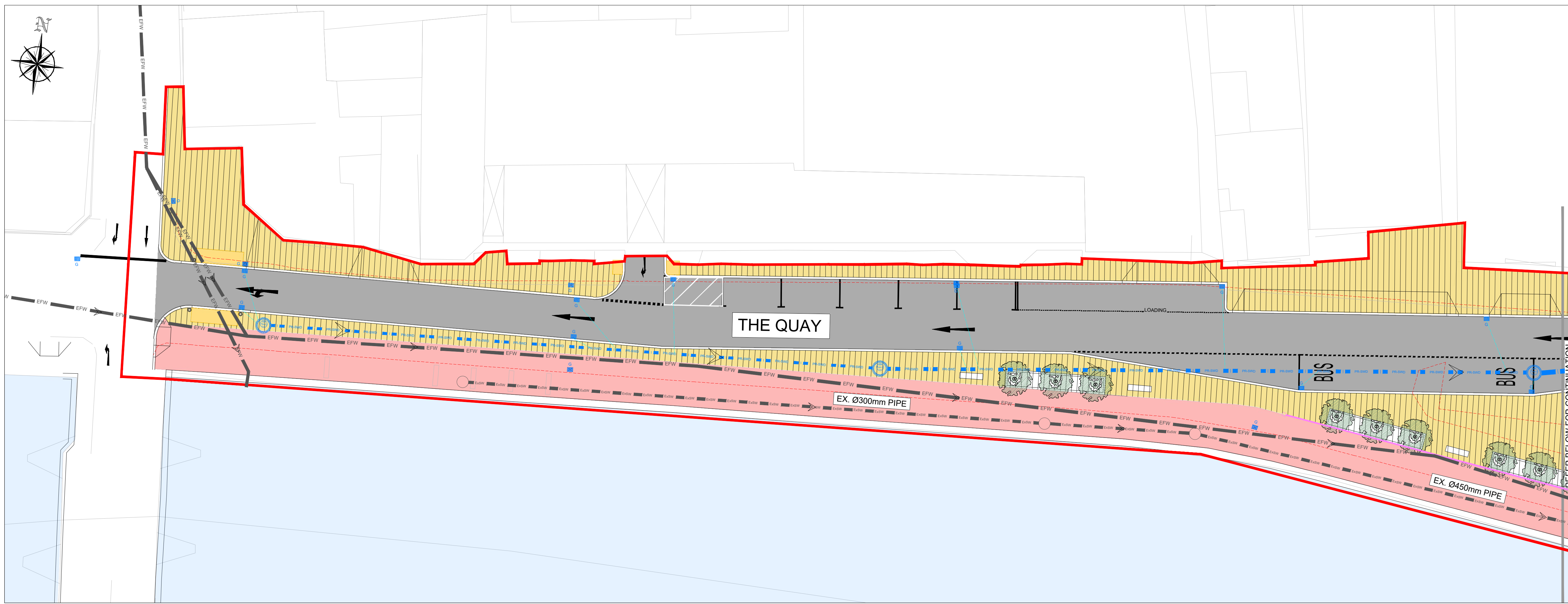

PLAN 1  
 SCALE 1:200



PLAN 2  
 SCALE 1:200

**LEGEND:**

**SITE BOUNDARY:**

- Red line: SITE BOUNDARY

**PROPOSED SURFACE WATER DRAINAGE:**

- Blue dashed line with arrow: PROPOSED STORM WATER PIPE
- Blue circle: PROPOSED STORM WATER MANHOLE
- Pink line: PROPOSED SLOT DRAIN
- Pink square: GATIC 308x308mm ACCESS BOX OR SIMILAR APPROVED
- Blue square with 'G': PROPOSED GULLY AS PER TII DETAIL CC-SCD-00510 AND GRATING AS PER TII CC-SCD-514

**PROPOSED FOUL WATER DRAINAGE:**

- Orange line: PROPOSED FOUL WATER PIPE
- Orange circle: PROPOSED FOUL WATER MANHOLE
- Orange square: PROPOSED PUMP STATION
- Orange rectangle: PROPOSED 24HR EMERGENCY STORAGE
- Orange oval: PROPOSED RELOCATED PUBLIC TOILET

**EXISTING SURFACE & FOUL WATER DRAINAGE:**

- Black dashed line with arrow: EXISTING SURFACE WATER PIPE
- Black circle: EXISTING SURFACE WATER MANHOLE
- Black square with 'G': EXISTING SURFACE WATER GULLY RETAINED
- Black line with arrow: EXISTING FOUL SEWER PIPE
- Black dashed line with arrow: EXISTING GULLY PIPE
- Black oval: EXISTING PUBLIC TOILET TO BE MOVED
- Red wavy line: EXISTING PIPE TO BE REMOVED
- Red square with 'G': EXISTING GULLY TO BE REMOVED

**NOTE:**

- GULLY CONNECTIONS TO BE 1500 PVC OR SIMILAR APPROVED UNLESS SHOWN OTHERWISE
- CONTRACTOR TO CONFIRM LOCATION OF EXISTING STORM WATER PIPES PRIOR TO COMMENCEMENT OF WORK
- ALL GULLIES TO BE PRECAST CONCRETE TO TII CC-SCD-00510
- ALL SLOT DRAINS AND DROP CONNECTORS TO BE "GATIC CAST SLOT TREAD-SAFE" OR SIMILARLY APPROVED
- ALL SLOT DRAIN ACCESS BOXES TO BE "GATIC 308x308mm ACCESS BOX" WITH RECESSED COVER OR SIMILAR APPROVED
- ALL INSPECTION CHAMBERS TO BE WAVIN 450mm INSPECTION CHAMBER OR SIMILARLY APPROVED

| Rev  | Description                      | Drawn | Checked | Date     |
|------|----------------------------------|-------|---------|----------|
| PL02 | ISSUED FOR PLANNING RFI RESPONSE | FO    | LP      | 06.08.24 |
| PL01 | ISSUED FOR PLANNING              | FO    | LP      | 22.09.23 |

 Clifton Scannell Emerson  
 Associates  
 Consulting Engineers,  
 3rd Floor The Highline,  
 Bakers Point, Pottery Road,  
 Dun Laoghaire, Co. Dublin,  
 Ireland, A96 KW29  
 T: +353 1 288 5006  
 F: +353 1 283 3466  
 E: info@csea.ie  
 W: www.csea.ie

TIPPERARY  
 COUNTY COUNCIL  
 Client  
 SUIR ISLAND  
 INFRASTRUCTURE LINKS  
 Project  
 PROPOSED COMBINED SW & FW LAYOUT  
 PLAN SHEET 01 OF 04  
 Dwg. Title

Drawn By: FO Date: SEPT 2023  
 Checked By: LP Scale: 1:200 @ A1  
 20\_071  
 CSEA Job No.

Project Code: 20\_071 - CSE - GEN - XX - DR - C - 2501  
 Originator: Zone/Phase: Level: Type: Role: Dwg. No.

S2 SUITABLE FOR INFORMATION  
 Status Code: Suitability Description

PL02 ISSUED FOR PLANNING  
 Revision: Project Status



**CLIENT**  
 Comhairle Contae Thiobraid Árann  
 Tipperary County Council

**ARCHITECTS** **ARCHEOLOGISTS**  
 

**BRIDGES** **ENGINEERS**  
 

**ENVIRONMENTAL CONSULTANTS**  
 

**LIGHTING CONSULTANTS**  

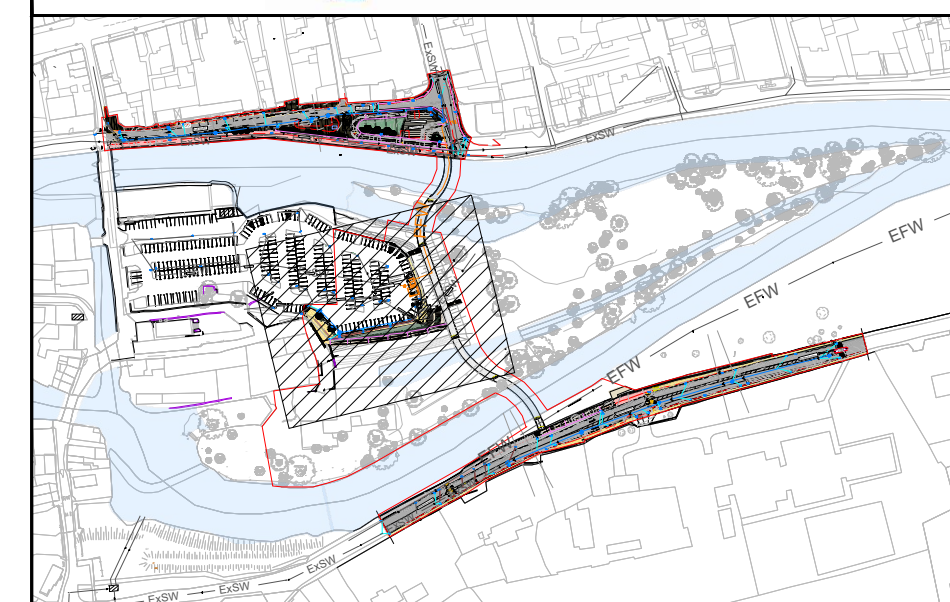
**KEYPLAN**  
SCALE N.T.S

| Rev  | Description                      | Drawn | Checked | Date     |
|------|----------------------------------|-------|---------|----------|
| PL02 | ISSUED FOR PLANNING RFI RESPONSE | FO    | LP      | 06.08.24 |
| PL01 | ISSUED FOR PLANNING              | FO    | LP      | 22.09.23 |

  
 Clifton Scannell Emerson Associates Limited  
 Consulting Engineers,  
 3rd Floor The Highline,  
 Bakers Point, Pottery Road,  
 Dun Laoighaire, Co. Dublin,  
 Ireland, A96 KW29  
 T: +353 1 288 5006  
 F: +353 1 283 3466  
 E: info@csea.ie  
 W: www.csea.ie

**TIPPERARY COUNTY COUNCIL**  
**SUIR ISLAND INFRASTRUCTURE LINKS**  
**PROPOSED COMBINED SW & FW LAYOUT**  
**PLAN SHEET 02 OF 04**

Client: TIPPERARY COUNTY COUNCIL  
 Project: INFRASTRUCTURE LINKS  
 Dwg. Title: PROPOSED COMBINED SW & FW LAYOUT PLAN SHEET 02 OF 04

Drawn By: FO Date: SEP 2023  
 LP Scale: 1:200 @ A1  
 Checked By: LP Scale: 1:200 @ A1  
 Project Code: Originator: Zone/Phase: Level: Type: Role: Dwg. No.  
 20\_071 - CSE - GEN - XX - DR - C - 2502

S2 SUITABLE FOR INFORMATION  
 Status Code: Suitability Description  
 PL02 ISSUED FOR PLANNING  
 Revision: Project Status

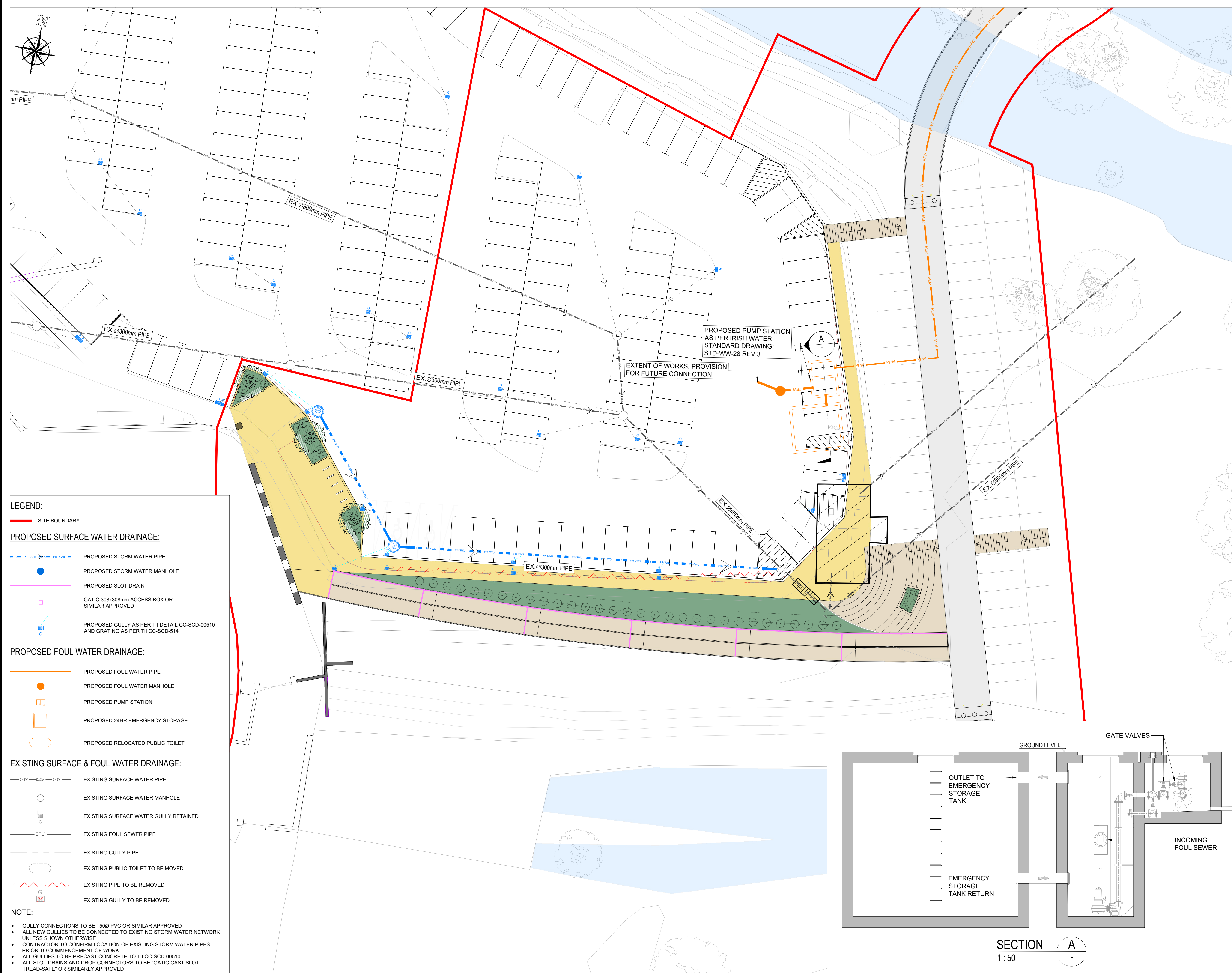

**PLAN 3**  
SCALE 1:200



**LEGEND:**

- SITE BOUNDARY
- PROPOSED STORM WATER PIPE
- PROPOSED STORM WATER MANHOLE
- PROPOSED SLOT DRAIN
- GATIC 308x308mm ACCESS BOX OR SIMILAR APPROVED
- G PROPOSED GULLY AS PER TII DETAIL CC-SCD-00510 AND GRATING AS PER TII CC-SCD-514
- PROPOSED FOUL WATER PIPE
- PROPOSED FOUL WATER MANHOLE
- PROPOSED PUMP STATION
- PROPOSED 24HR EMERGENCY STORAGE
- PROPOSED RELOCATED PUBLIC TOILET
- EXISTING SURFACE WATER PIPE
- EXISTING SURFACE WATER MANHOLE
- G EXISTING SURFACE WATER GULLY RETAINED
- EXISTING FOUL SEWER PIPE
- EXISTING GULLY PIPE
- EXISTING PUBLIC TOILET TO BE MOVED
- ~ EXISTING PIPE TO BE REMOVED
- G EXISTING GULLY TO BE REMOVED

- NOTE:**
- GULLY CONNECTIONS TO BE 150Ø PVC OR SIMILAR APPROVED
  - ALL NEW GULLIES TO BE CONNECTED TO EXISTING STORM WATER NETWORK UNLESS SHOWN OTHERWISE
  - CONTRACTOR TO CONFIRM LOCATION OF EXISTING STORM WATER PIPES PRIOR TO COMMENCEMENT OF WORK
  - ALL GULLIES TO BE PRECAST CONCRETE TO TII CC-SCD-00510
  - ALL SLOT DRAINS AND DROP CONNECTORS TO BE "GATIC CAST SLOT TREADSAFE" OR SIMILARLY APPROVED
  - ALL SLOT DRAIN ACCESS BOXES TO BE "GATIC 308x308mm ACCESS BOX" WITH RECESSED COVER OR SIMILAR APPROVED
  - ALL INSPECTION CHAMBERS TO BE WAVIN 450mm INSPECTION CHAMBER OR SIMILARLY APPROVED

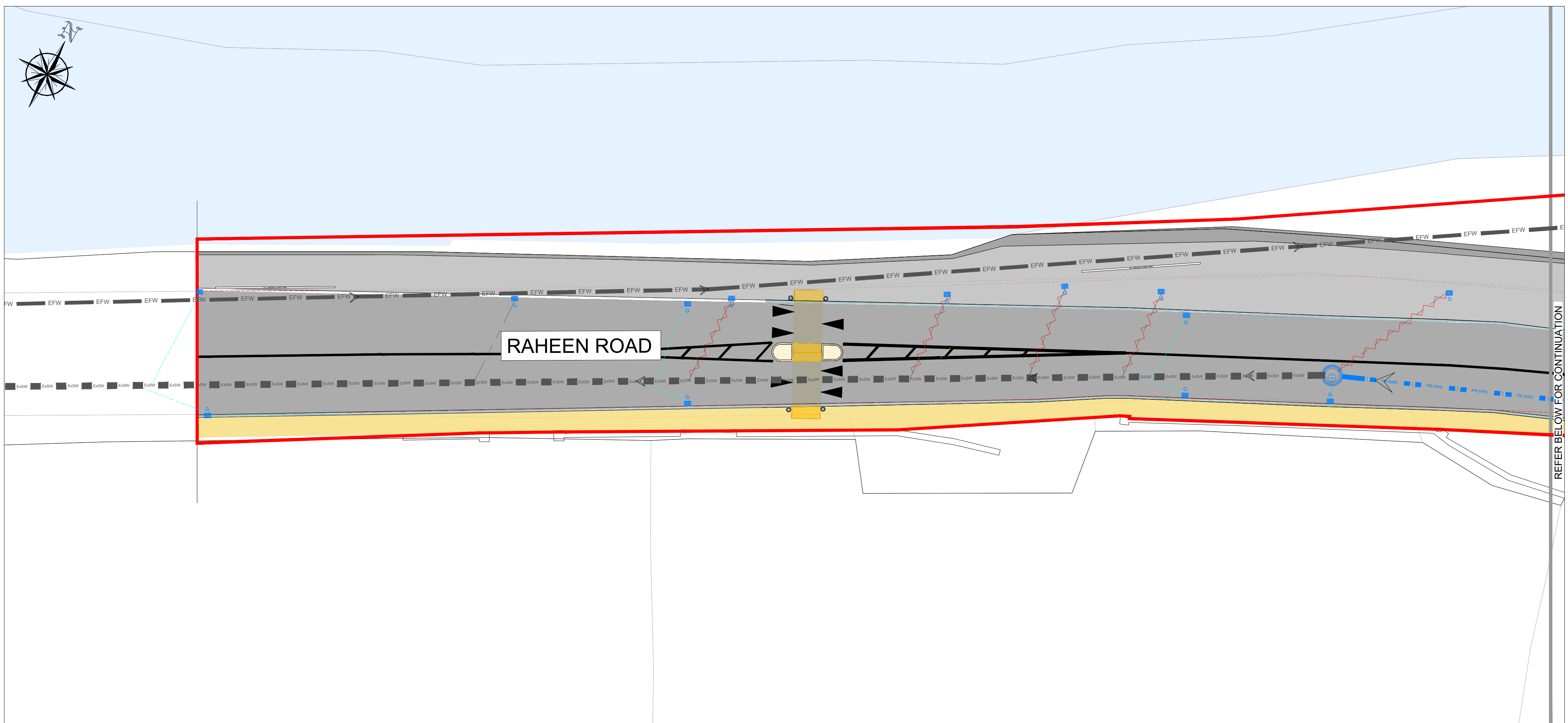

**PLAN 4**  
SCALE 1:200

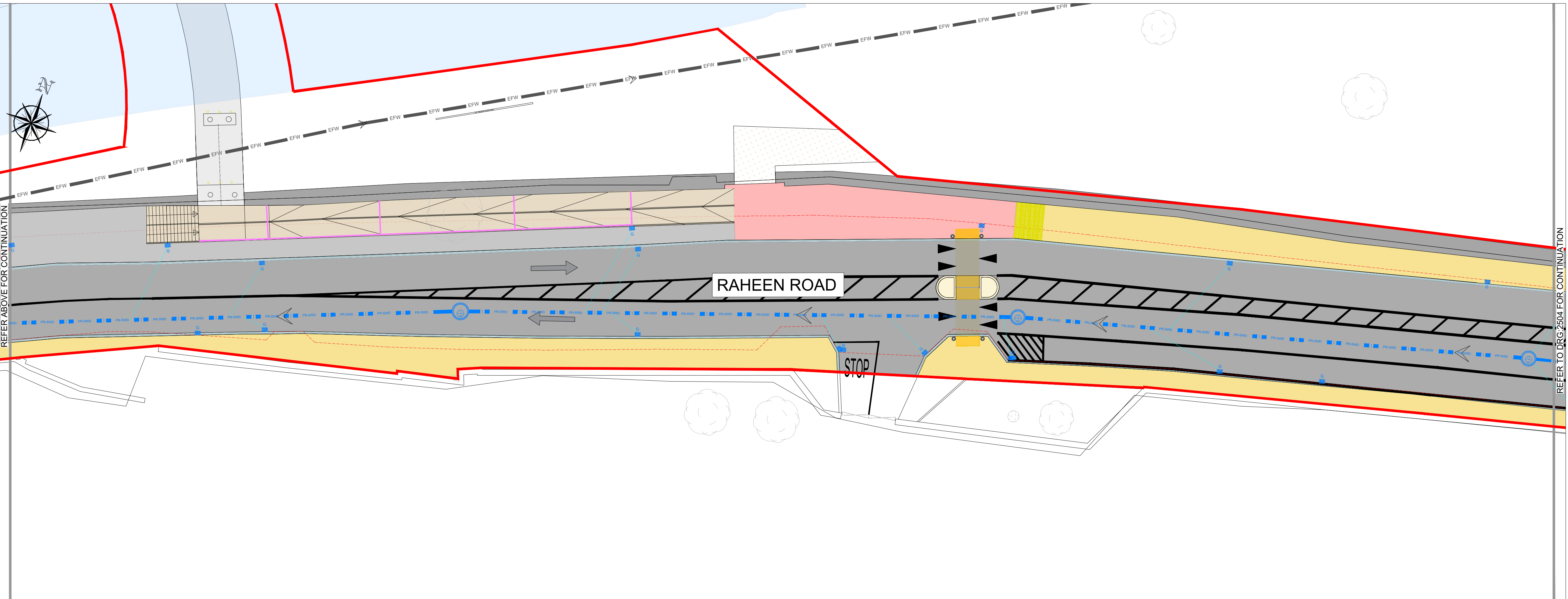

**PLAN 5**  
SCALE 1:200

**CLIENT**  

 Comhairle Contae Thiebraid Árann  
 Tipperary County Council

**ARCHITECTS** **ARCHEOLOGISTS**

**BRIDGES** **ENGINEERS**

**ENVIRONMENTAL CONSULTANTS**

**LIGHTING CONSULTANTS**

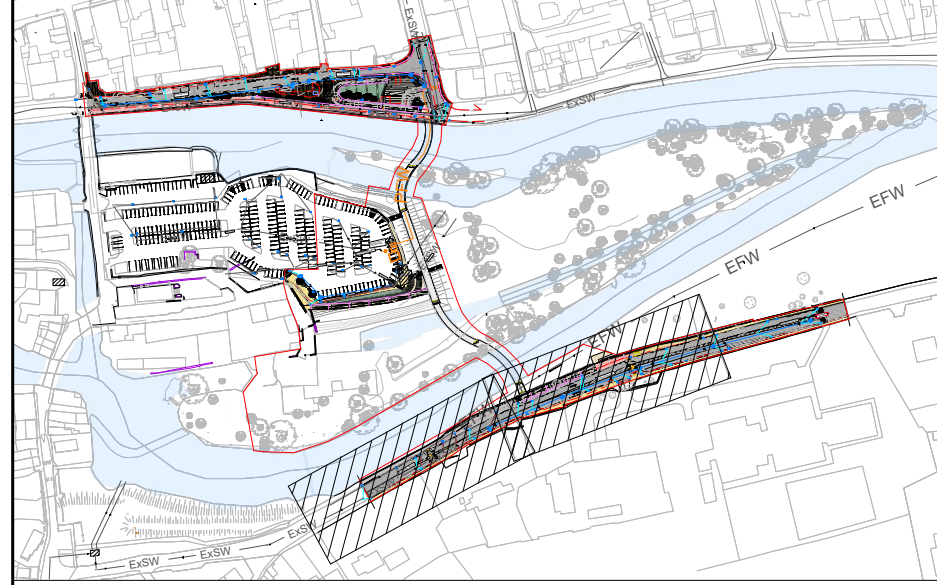

**KEYPLAN**  
SCALE N.T.S

| Rev  | Description                      | Drawn | Checked | Date     |
|------|----------------------------------|-------|---------|----------|
| PL02 | ISSUED FOR PLANNING RFI RESPONSE | FO    | LP      | 06.08.24 |
| PL01 | ISSUED FOR PLANNING              | FO    | FO      | 22.09.23 |

**Clifton Scannell Emerson Associates**  
 Consulting Engineers  
 3rd Floor The Highline,  
 Bakers Point, Pottery Road,  
 Dun Laoighaire, Co. Dublin,  
 Ireland, A96 KW29  
 T: +353 1 288 5006  
 F: +353 1 283 3466  
 E: info@csea.ie  
 W: www.csea.ie

**TIPPERARY COUNTY COUNCIL**

**Client**  
SUIR ISLAND

**Project**  
INFRASTRUCTURE LINKS

**Dwg. Title**  
PROPOSED COMBINED SW & FW LAYOUT  
PLAN SHEET 03 OF 04

|                      |                       |                         |               |
|----------------------|-----------------------|-------------------------|---------------|
| <b>Drawn By</b> FO   | <b>Date</b> SEPT 2023 | <b>Scale</b> 1:200 @ A1 | <b>20_071</b> |
| <b>Checked By</b> LP |                       |                         | CSEA Job No.  |

| Project Code | Originator | Zone/Phase | Level | Type | Role | Dwg. No. |
|--------------|------------|------------|-------|------|------|----------|
| 20_071       | CSE        | GEN        | XX    | DR   | C    | 2503     |

**S2** SUITABLE FOR INFORMATION  
 Status Code Suitability Description

**PL02** ISSUED FOR PLANNING  
 Revision Project Status



CLIENT  
 Comhairle Contae Thiobraid Árann  
 Tipperary County Council

ARCHITECTS ARCHITECTS  
  CourtneyDeery  
 ARCHITECTS & CULTURAL HERITAGE

BRIDGES ENGINEERS  
  Clifton Scannell Emerson  
 ARCHITECTURE ASSOCIATES  
 INGÉNIÉRIE

ENVIRONMENTAL CONSULTANTS  
  awnconsulting  
 A Trinity Consultants Company

LIGHTING CONSULTANTS  
 Douglas Carroll  
 Consulting Engineers

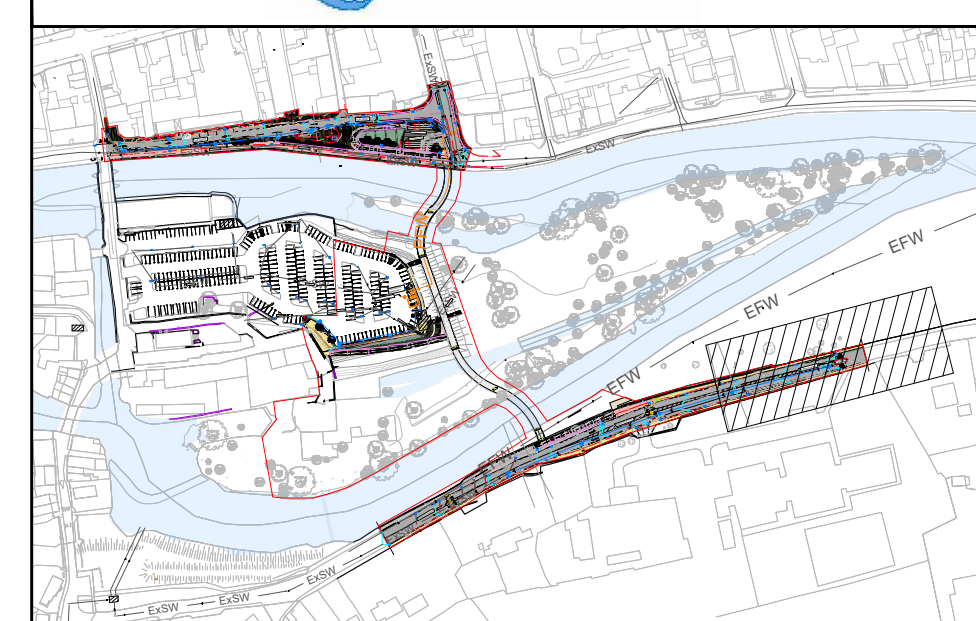





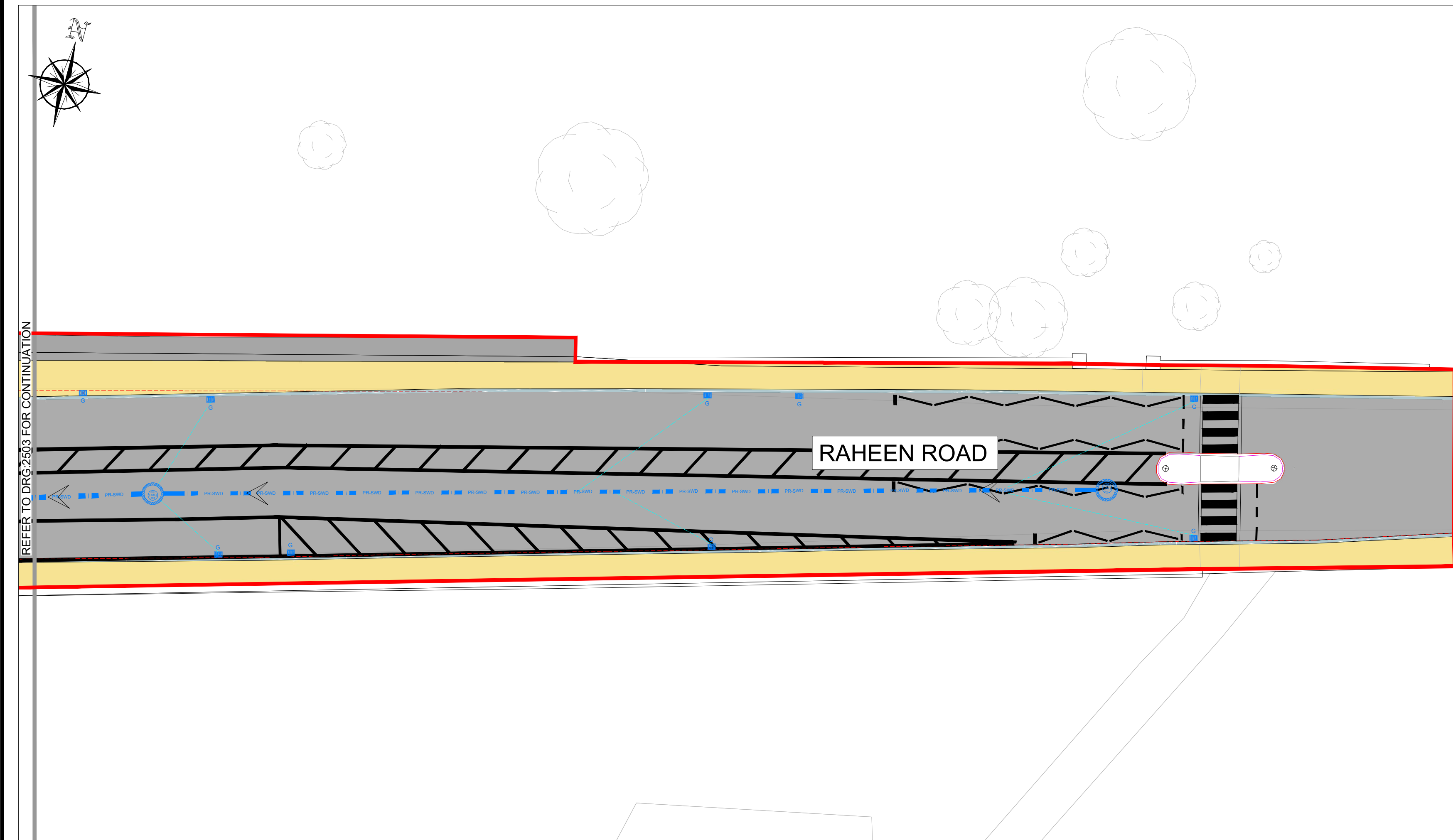





KEYPLAN  
 SCALE N.T.S









REFER TO DRG 2003 FOR CONTINUATION



PLAN 6  
 SCALE 1:200

- LEGEND:
-  SITE BOUNDARY
  - PROPOSED SURFACE WATER DRAINAGE:**
  -  PROPOSED STORM WATER PIPE
  -  PROPOSED STORM WATER MANHOLE
  -  PROPOSED SLOT DRAIN
  -  GATIC 308x308mm ACCESS BOX OR SIMILAR APPROVED
  -  PROPOSED GULLY AS PER TII DETAIL CC-SCD-00510 AND GRATING AS PER TII CC-SCD-514

- PROPOSED FOUL WATER DRAINAGE:**
-  PROPOSED FOUL WATER PIPE
  -  PROPOSED FOUL WATER MANHOLE
  -  PROPOSED PUMP STATION
  -  PROPOSED 24HR EMERGENCY STORAGE
  -  PROPOSED RELOCATED PUBLIC TOILET

- EXISTING SURFACE & FOUL WATER DRAINAGE:**
-  EXISTING SURFACE WATER PIPE
  -  EXISTING SURFACE WATER MANHOLE
  -  EXISTING SURFACE WATER GULLY RETAINED
  -  EXISTING FOUL SEWER PIPE
  -  EXISTING GULLY PIPE
  -  EXISTING PUBLIC TOILET TO BE MOVED
  -  EXISTING PIPE TO BE REMOVED
  -  EXISTING GULLY TO BE REMOVED

- NOTE:
- GULLY CONNECTIONS TO BE 150Ø PVC OR SIMILAR APPROVED
  - ALL NEW GULLIES TO BE CONNECTED TO EXISTING STORM WATER NETWORK UNLESS SHOWN OTHERWISE
  - CONTRACTOR TO CONFIRM LOCATION OF EXISTING STORM WATER PIPES PRIOR TO COMMENCEMENT OF WORK
  - ALL GULLIES TO BE PRECAST CONCRETE TO TII CC-SCD-00510
  - ALL SLOT DRAINS AND DROP CONNECTORS TO BE "GATIC CAST SLOT TREAD-SAFE" OR SIMILARLY APPROVED
  - ALL SLOT DRAIN ACCESS BOXES TO BE "GATIC 308x308mm ACCESS BOX" WITH RECESSED COVER OR SIMILAR APPROVED
  - ALL INSPECTION CHAMBERS TO BE WAVIN 450mm INSPECTION CHAMBER OR SIMILARLY APPROVED



FIGURE 1:  
 NATURE-BASED SOLUTIONS (NB SUDs): STOCKHOLM METHOD FOR PLANTED TREES

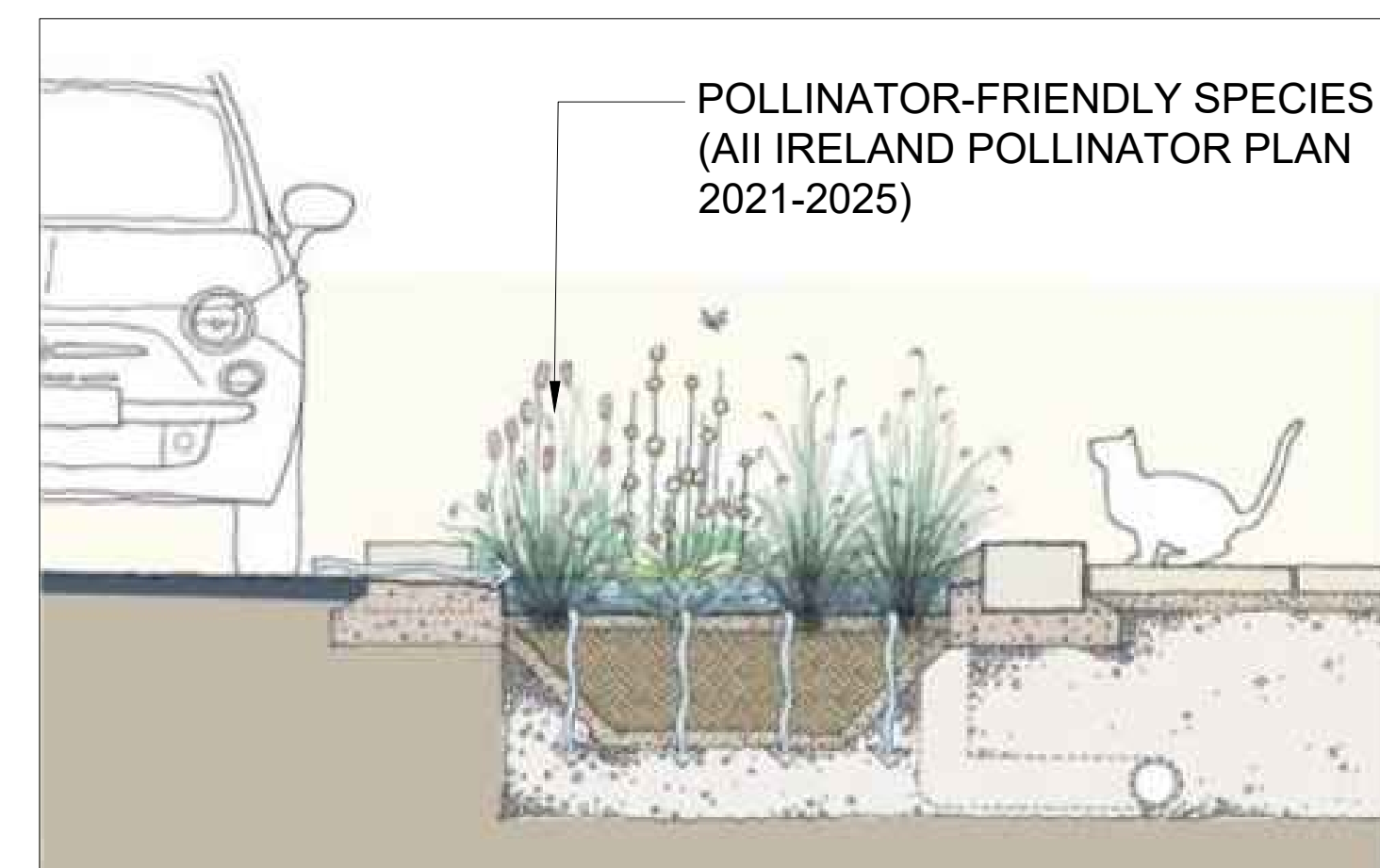

FIGURES 2 & 3:  
 NATURE-BASED SOLUTIONS (NB SUDs) RAIN GARDENS DRAINAGE SOLUTIONS FOR LANDSCAPING

| Rev  | Description                      | Drawn | Checked | Date     |
|------|----------------------------------|-------|---------|----------|
| PL02 | ISSUED FOR PLANNING RFI RESPONSE | FO    | LP      | 06.08.24 |
| PL01 | ISSUED FOR PLANNING              | FO    | LP      | 22.09.23 |

 Clifton Scannell Emerson  
 Associates  
 Consulting Engineers, 3rd Floor The Highline, Bakers Point, Pottery Road, Dun Laoighaire, Co. Dublin, Ireland, A96 KW29  
 T: +353 1 288 5006  
 F: +353 1 283 3466  
 E: info@csea.ie  
 W: www.csea.ie

TIPPERARY COUNTY COUNCIL  
 SUIR ISLAND INFRASTRUCTURE LINKS  
 PROPOSED COMBINED SW & FW LAYOUT  
 PLAN SHEET 04 OF 04

|              |            |            |            |        |      |          |
|--------------|------------|------------|------------|--------|------|----------|
| Drawn By     | FO         | Date       | SEPT 2023  | 20_071 |      |          |
| Checked By   | LP         | Scale      | 1:200 @ A1 |        |      |          |
| Project Code | Originator | Zone/Phase | Level      | Type   | Role | Dwg. No. |
| 20_071       | CSE        | GEN        | XX         | DR     | C    | 2504     |

S2 SUITABLE FOR INFORMATION  
 Status Code Suitability Description  
 PL02 ISSUED FOR PLANNING  
 Revision Project Status